

NILFISK[®] **Combat**

Instructions for use

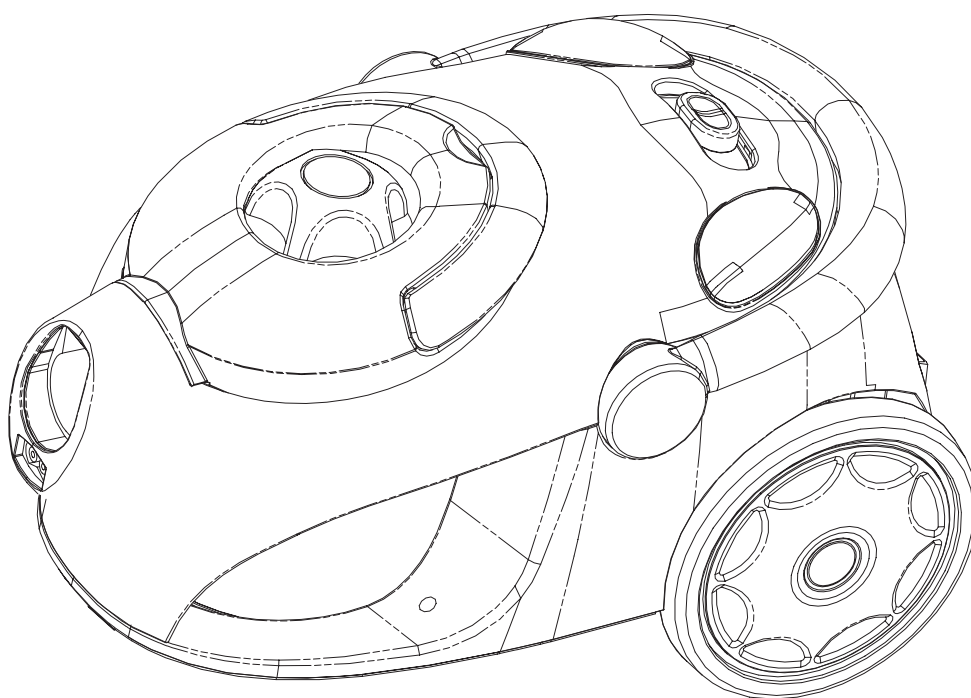

www.nilfisk-advance.com

Safety instructions

- Do not use the machine without filters properly fitted.
- This machine is not intended for the suction of hazardous materials such as plaster, gib dust and asbestos or gas, doing so may expose people to serious health risks.
- The machine must not be used for the suction of water or other liquids.
- Do not pick up sharp objects such as needles or pieces of glass.
- Do not pick up anything that is burning or smoking such as cigarettes, matches or hot ashes.
- Use and store this machine indoors and in a dry environment, 0 °C to 60 °C.
- Do not use the machine outdoors.
- Do not handle the machine with wet hands.
- Turn off the machine before unplugging.
- To unplug, grasp the plug, not by pulling on the cord. Do not carry or pull the machine by the cord.
- The machine must not be used if the cord shows any sign of damage. Regularly inspect the cord for damage, in particular if it has been crushed, shut in a door or run over.
- Do not use the machine if it appears faulty. Have the machine inspected by an authorized service center if the machine has been dropped, damaged, left outdoors or has been exposed to water.
- No changes or modifications to the mechanical or electrical safety devices should be made.
- All repairs must be carried out by an authorized service center.
- Use only original filters and original accessories from your local dealer. Use of unauthorized filters will void the warranty.
- Turn off the machine and unplug before starting filter change, grasp the plug, not by pulling on the cord.
- Do not use the machine as a toy. Do not leave children with the machine without supervision.
- This appliance is not intended for use by young persons or infirm persons without supervision unless they have been adequately supervised by a responsible person to ensure that they can use the appliance safely. Young children should be supervised to ensure that they do not play with the appliance.
- If the supply cord is damaged, it must be replaced by the manufacturer or its service agent or similar qualified person in order to avoid a hazard.

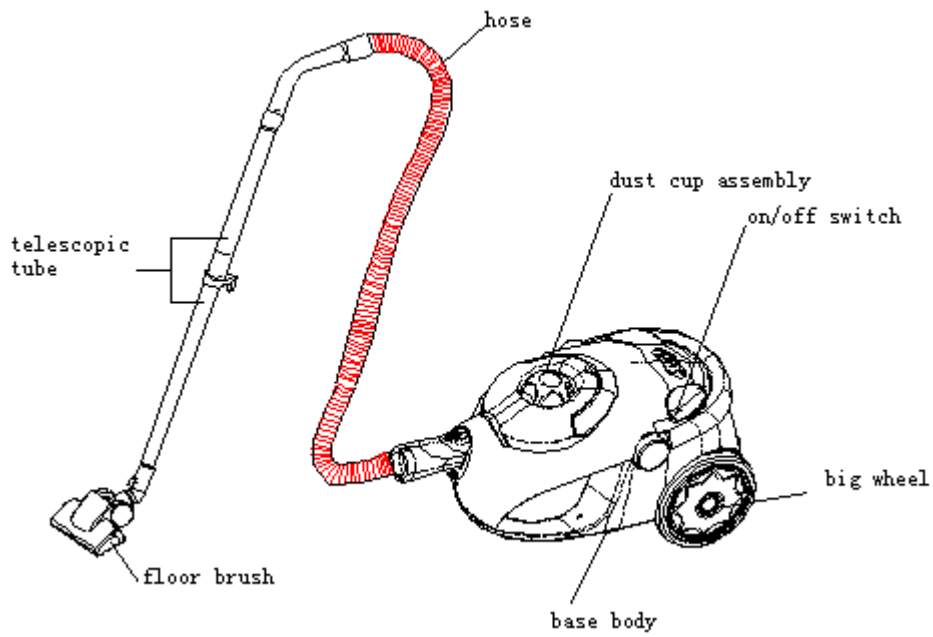

CLEANER SKETCH MAP

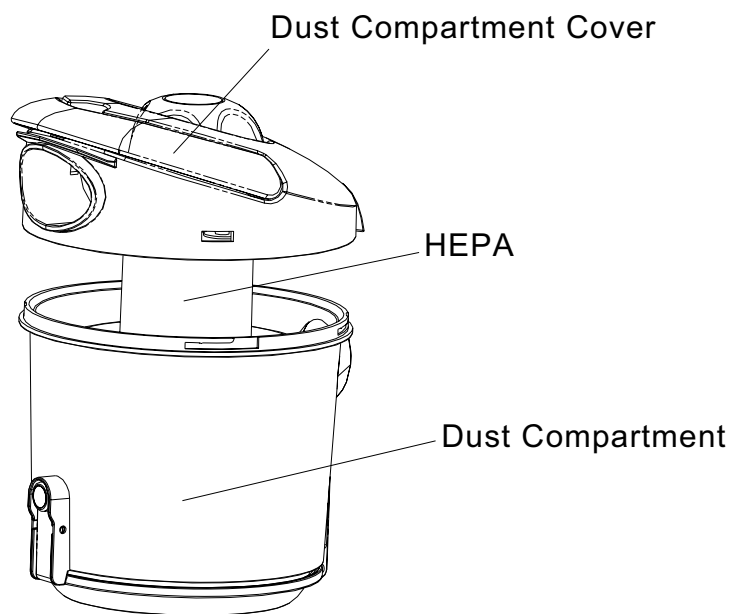

DUST COMPARTMENT SUBASSEMBLY SKETCH MAP

PRECAUTIONARY MEASURES

If the opening that sucks in the air, the suction pipe or the telescopic wand or pipe are blocked, you should switch off the vacuum cleaner at once. First clear the blocked substance before you attempt to start the vacuum cleaner again.

1. Do not operate the vacuum cleaner too close to heaters and like radiators, cigarette butts etc.

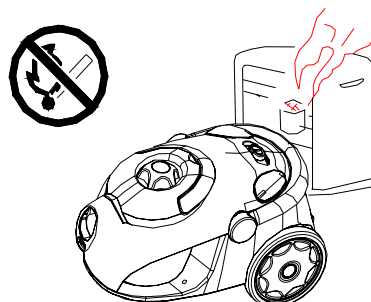

2. Before you insert the plug into the wall contact, make sure your hand is dry.

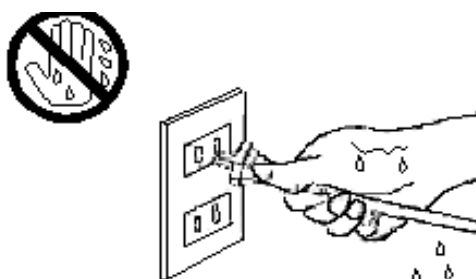

3. Before you start using the vacuum cleaner, please remove large or sharp objects from the floor in order to prevent that the HEPA filter is damaged.

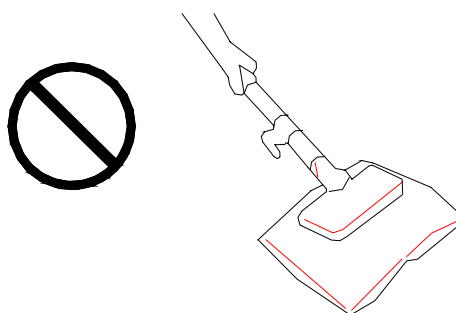

4. When you want to pull the plug from the wall contact, please do this at the plug itself and not by means of the electrical cable.

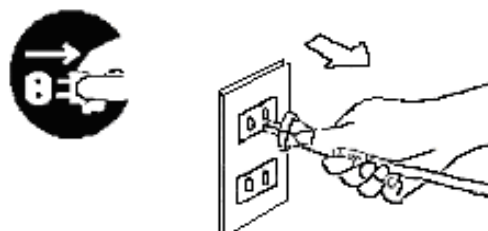

This vacuum cleaner is equipped with a plug and a cable, which rewinds automatically. If anything gets damaged, both the plug and the cable must be repaired by a qualified repairman or electrician.

ASSEMBLING VACUUM CLEANER

Always remove the plug from the power socket before fitting or removing accessories!

1. Connecting vacuum cleaner

1. Fitting or removing the flexible hose

Fitting:

Insert flexible hose into the air intake duct on the front of appliance. Press until it clicks into position.

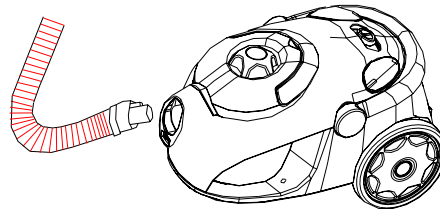

Removing:

Removing the plug from the power socket. To release the flexible hose firmly from the air intake duct.

2. Fitting the extension tubes and accessories

a. Fitting the telescopic tube to the handle.

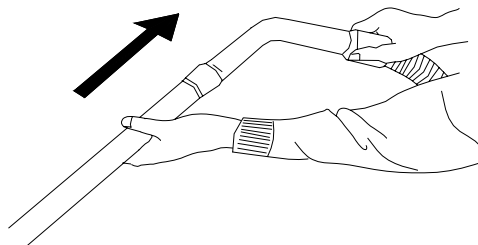

b. Fitting the nozzle to the telescopic tube.

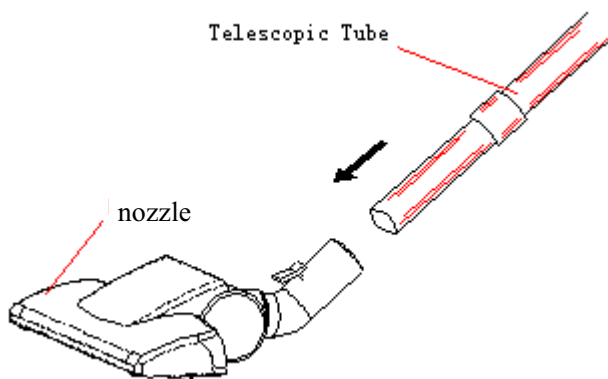

c. Fitting Floor nozzle

Ideal for the daily cleaning on carpets and hard floors.

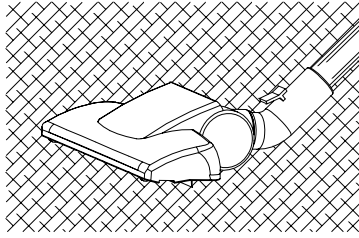

Clean on the carpet

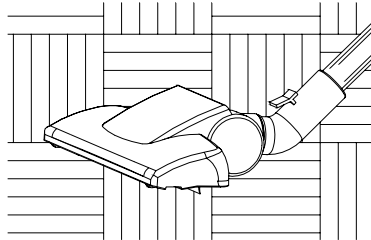

Clean on the hard floor

d. Extra nozzles

Hard floor nozzle

Use the nozzle for hard floors.

Turbo nozzle

Use the turbo nozzle for efficient carpet cleaning.

2.Cleaning tools use

The crevice tool and dusting brush are stored on the accessories holder.

1.Crevise tool:

For radiators, crevices, corners, baseboards and between cushions.



2.Dusting brush is used for the furniture,venetian, blinds, lamp shades and shelves.



INSTRUCTIONS FOR USE

Before using appliance, unwind a sufficient length of cable and insert the plug into the power socket. A yellow mark on the power cable shows the ideal cable length. Don't extend the cable beyond the red mark.

1. Press the ON/OFF button to switch the appliance on.

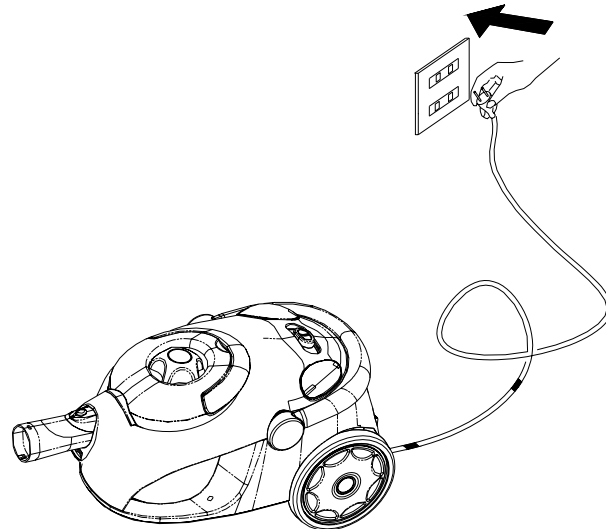

2. To rewind the power cable, press the rewind button with one hand and guide the cable with the other hand to ensure that it does not whip causing damage.

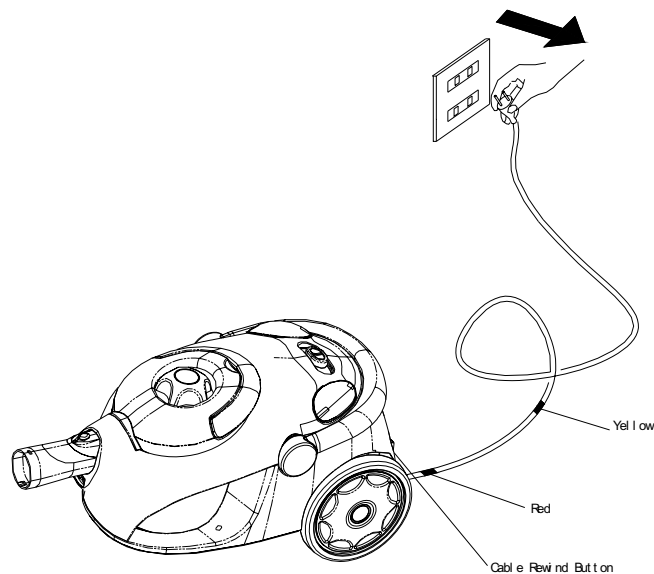

MAINTENANCE

1. Spilling rubbish from the dust compartment subassembly

- Always operate the cleaner with the dust compartment subassembly installed.
- If you forget to attach HEPA and filter or attach it in a wrong manner, the dust compartment subassembly may not rinse.

1. After removing the flexible tube, hold handle and press the locking button.

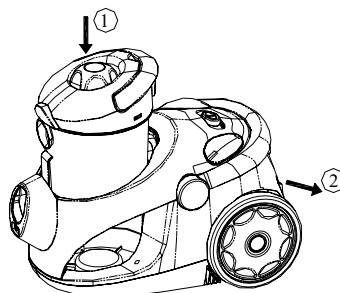

2. Carry the dust compartment subassembly.

3. Carry away the dust-glass cap and empty rubbish

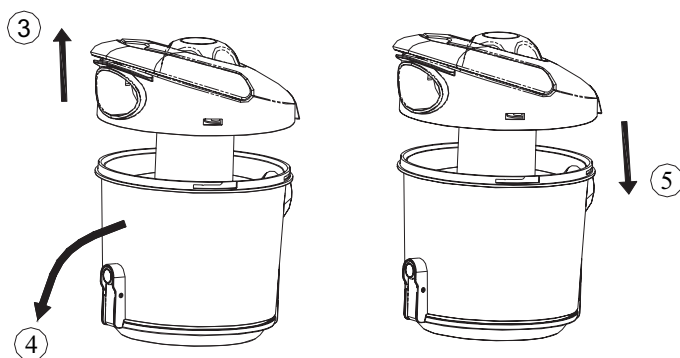

4. Empty rubbish and fix the dust compartment subassembly.

5. Replace the dust compartment subassembly until it is locked.

2. Cleaning and changing filter or HEPA

- Filter for air-inlet should be cleaned at least twice a year or when it becomes visible solid.
- Clean HEPA for air-let when you find it is filled in.
- HEPA for air-inlet and filter for air-outlet are changed.
- Always operate the cleaner with filters and HEPA installed. Otherwise, reduced suction or motor damage may be result.
- Disconnect from electrical outlet, before cleaning filter.
- Do not use a washing machine to rinse filter.
- Do not use hair drier to dry it.
- Cleaning and changing filter and HEPA for air-inlet
- Dry filter in the shade only

- (1) After opening the dust compartment subassembly, rotate HEPA until it is unlocked
- (2) Remove HEPA.

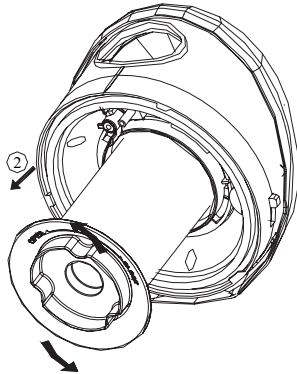

- (3) Rinse filter and HEPA in lukewarm water and dry Filter and HEPA completely. (HEPA is rinsed by brush.)

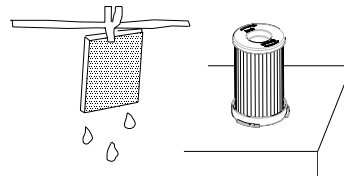
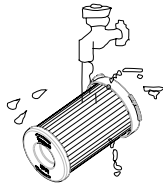
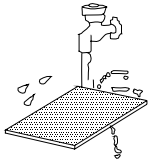

- (5) Put the filter into the Grille-Filter and rotate HEPA or change new HEPA, then put them back.

2.Changing filter for air-outlet

- (1) Open the grille for air-outlet.
- (2) When open the grille for air-outlet, the filter for air-outlet is found.
- (3) Take the filter out and change a clean one.
- (4) Close the grille for air-outlet.

Guarantee and service

This Nilfisk Combat vacuum cleaner is covered by a two (2) year guarantee on the machine, which covers the motor, cable rewinder, switch and casing. The nozzles, filters, hoses, tubes and other accessories are covered twelve months due to manufacturing fault only and excludes wear and tear.

The guarantee includes spare parts and labour costs, and covers manufacturing and material defects that may occur during normal domestic use.

Service under the guarantee will only be performed if it can be proven that the defect occurred within the product's guarantee period (a correctly completed guarantee certificate or printed/stamped cash register receipt with date and product type) and on the condition that the vacuum cleaner was bought as a new product in Australia/New Zealand and distributed by Nilfisk-Advance. In the event of the repair of defects, the customer must contact Nilfisk-Advance to be directed to a service agent at the customer's own expense. Upon completion of any repairs necessary, the vacuum cleaner will be returned to the customer at the risk and expense of Nilfisk-Advance.

The guarantee does not cover:

- Normal wear and tear of accessories and filters.
- Defects or damage occurring as a direct or indirect result of incorrect use - such as the vacuuming of rubble, hot ashes, fine talcum powder, gyprock or carpet deodorant powder.
- Abuse, loss or lack of maintenance as described in Instructions for use.

- If the machine has been used for home renovations.
- If the machine has been used for suction of water, plaster dust or sawdust.

Nor will it cover incorrect or poor configuration, i.e. setting up or connection, nor fire-damage, fire, lightning strike or unusual voltage fluctuations or any other electrical disturbances such as defective fuses or defective electrical installations on the supply grid, and defects or damage in general that Nilfisk-Advance consider to be the result of causes other than manufacturing and material defects.

The guarantee becomes void:

- If a defect is caused by the use of non-original Nilfisk filters.
- If the identity number is removed from the vacuum cleaner.
- If the vacuum cleaner has been repaired by a non-Nilfisk authorized dealer.
- If the machine is used in a commercial environment, i.e. building contractors, cleaning contractors, professional trades or any other non-domestic usage.

The guarantee is valid in:

Australia Customer Care helpline:
Telephone 1300 733 171

New Zealand:
FreePhone 0800 40 80 80

WHEELIE Symbol Information

English



Correct Disposal of This Product (Waste Electrical & Electronic Equipment)

(Applicable in the European Union and other European countries with separate collection systems)
This marking shown on the product or its literature, indicates that it should not be disposed with other household wastes at the end of its working life. To prevent possible harm to the environment or human health from uncontrolled waste disposal, please separate this from other types of wastes and recycle it responsibly to promote the sustainable reuse of material resources. Household users should contact either the retailer where they purchased this product, or their local government office, for details of where and how they can take this item for environmentally safe recycling.

Business users should contact their supplier and check the terms and conditions of the purchase contract. This product should not be mixed with other commercial wastes for disposal.