

**To be performed by a skilled or instructed person only !**

**Disconnect the vacuum cleaner from the power supply before starting the work!**

① Models with bag-full indicator: Open the dust cover until it stops and continue with a little pressure by hand until it slides free of the hinges.

Models with no bag-full indicator: Open the dust cover and lift it out of the hinges.

Remove filter with dust bag.

Remove the dust bag holder by pressing bottom clip and ease the holder out of the bottom. This releases the hook at the container wall.

② To separate the top and bottom housing and avoid scratches on the parts, place tool no. 22361400 under the buffer.

Follow instruction 82361500

Remove the strap (12) by hand. Lift up the buffer and remove the top housing.

③ Free the cord with plug from the terminal box in the top housing by using a Pozi screwdriver no. 2 or in old models press it out by hand.

Remove the cord reel and lock the cord to the reel. Remove internal wires and release the on/off switch by pressing a screwdriver under it. Remove the motor housing with four screws by a Pozi screwdriver no. 2.

Replace the motor unit with the new complete motor housing included the thermal switch and connect wires as described.

Refit in reverse order. Press the buffer back in place by hand after mounting the strap around the housings.

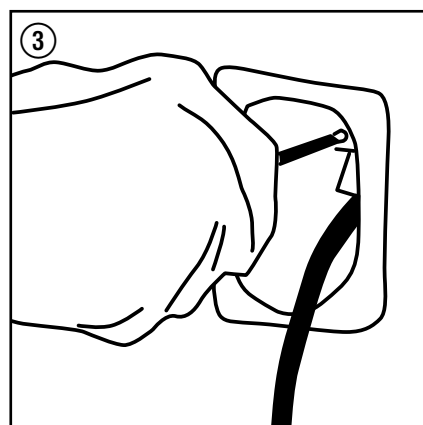
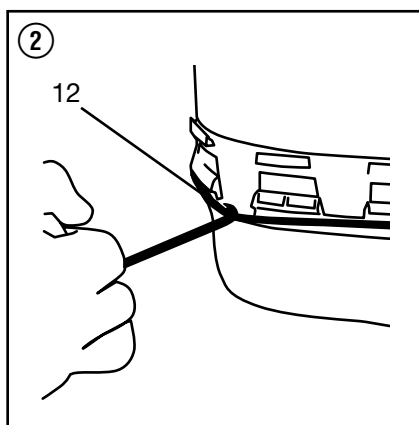
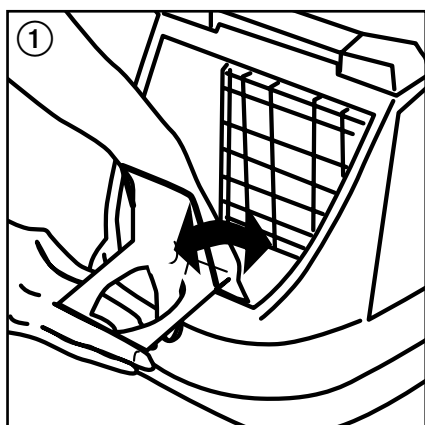

### Note 1:

O-ring to be mounted only when existing motor housing is for two speed regulation with four grooves.

View with existing motor housing removed.

Remove and scrap these when your are installing a new motor unit on a GM 200 / 300

81859300

81842700

81842800

81842900

81841900

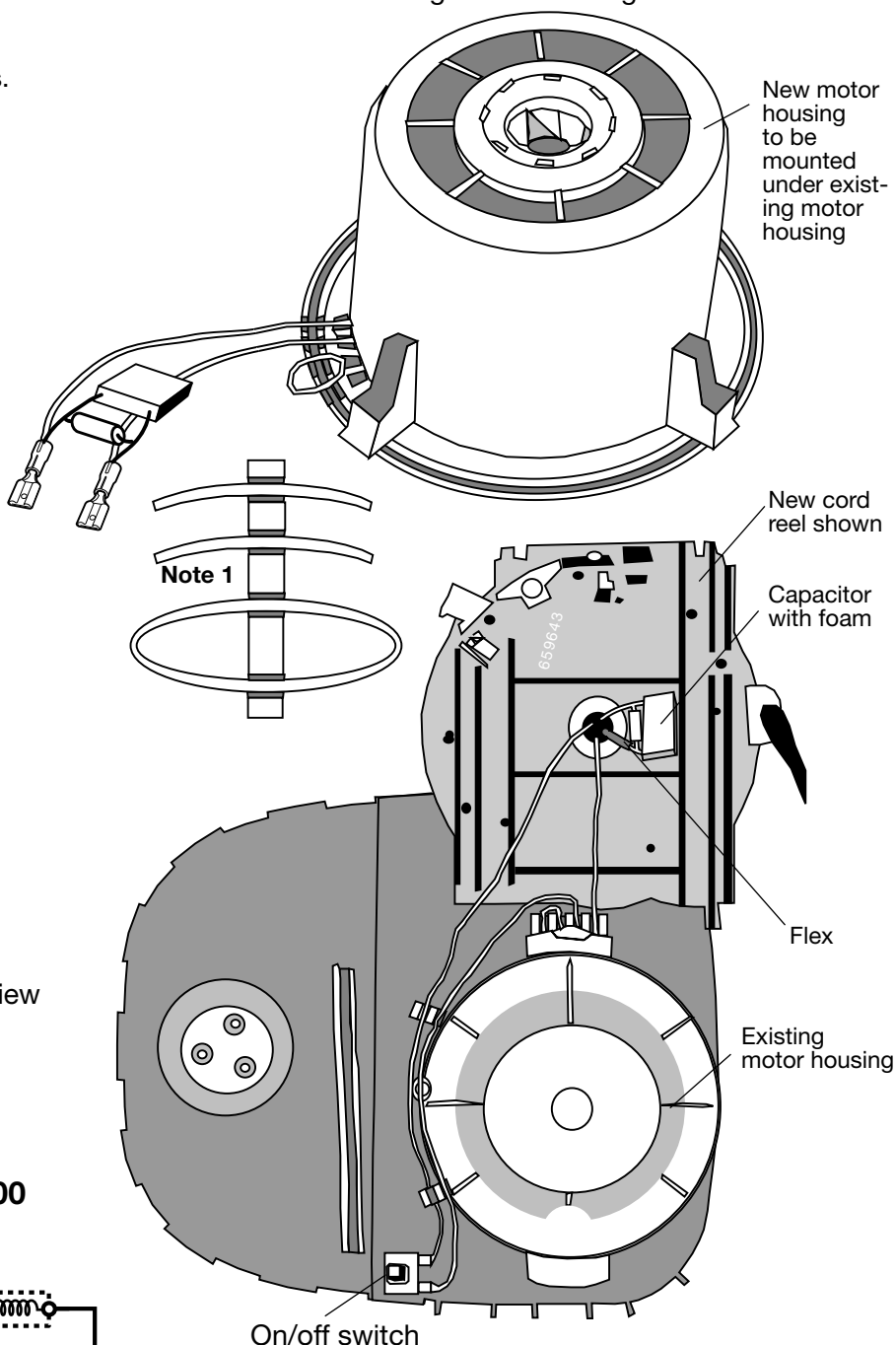

Top view

Diagram for GM 200/300/400 series with one speed

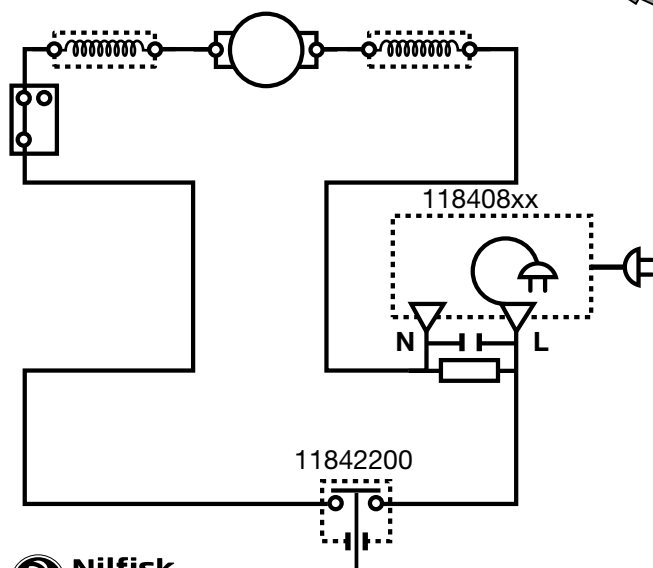

= RFI capacitor

= Thermo switch

= Resistor

## 22186000. Replacement with the new 1200W motor kit and two speed PCB

A-0.6.5.

3

**To be performed by a skilled or instructed person only !**

**Disconnect the vacuum cleaner from the power supply before starting the work!**

① Models with bag-full indicator: Open the dust cover until it stops and continue with a little pressure by hand until it slides free of the hinges.

Models with no bag-full indicator: Open the dust cover and lift it out of the hinges.

Remove filter with dust bag.

Remove the dust bag holder by pressing bottom clip and ease the holder out of the bottom. This releases the hook at the container wall.

② To separate the top and bottom housing and avoid scratches on the parts, place tool no. 22361400 under the buffer.

Follow instruction 82361500

Remove the strap (12) by hand. Lift up the buffer and remove the top housing.

③ Free the cord with plug from the terminal box in the top housing by using a Pozi screwdriver no. 2 or in old models press. it out by hand.

Remove the cord reel and lock the cord to the reel. Remove internal wires and release the on/off switch by pressing a screwdriver under it.

Replace the motor unit with the new complete motor housing included the thermal switch and connect wires as described. Remove and replace the new two-speed PCB and connect wires.

Refit in reverse order. Press the buffer back in place by hand after mounting the strap around the housings.

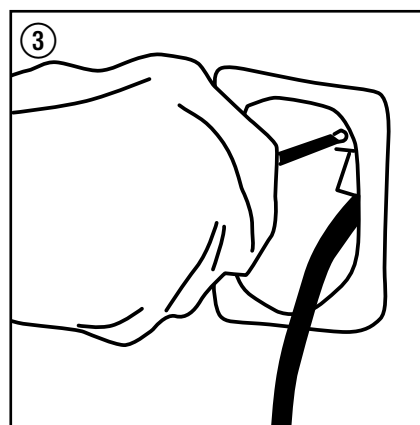
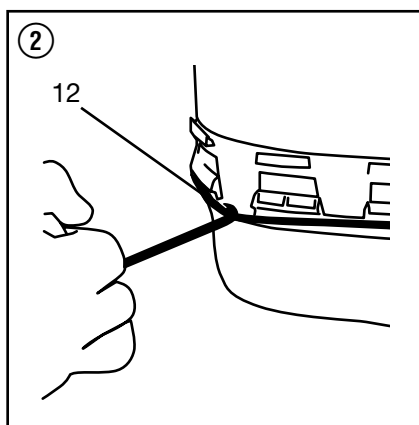
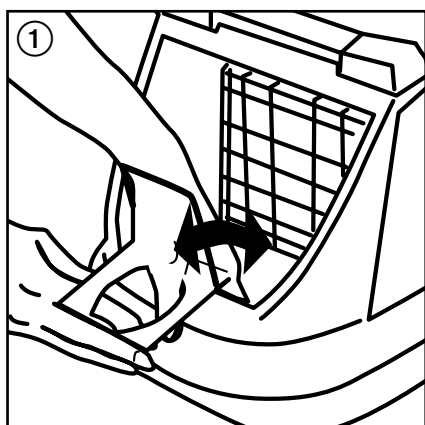

## 22186000. Replacement with the new 1200W motor kit and two speed PCB

A-0.6.5.

4

View with existing motor housing removed.

### Note 1:

Internal blue wire to be turned up and locked by a strap. (Only two speed version).

### Note 2:

O-ring to be mounted only when existing motor housing is for two speed regulation with four grooves.

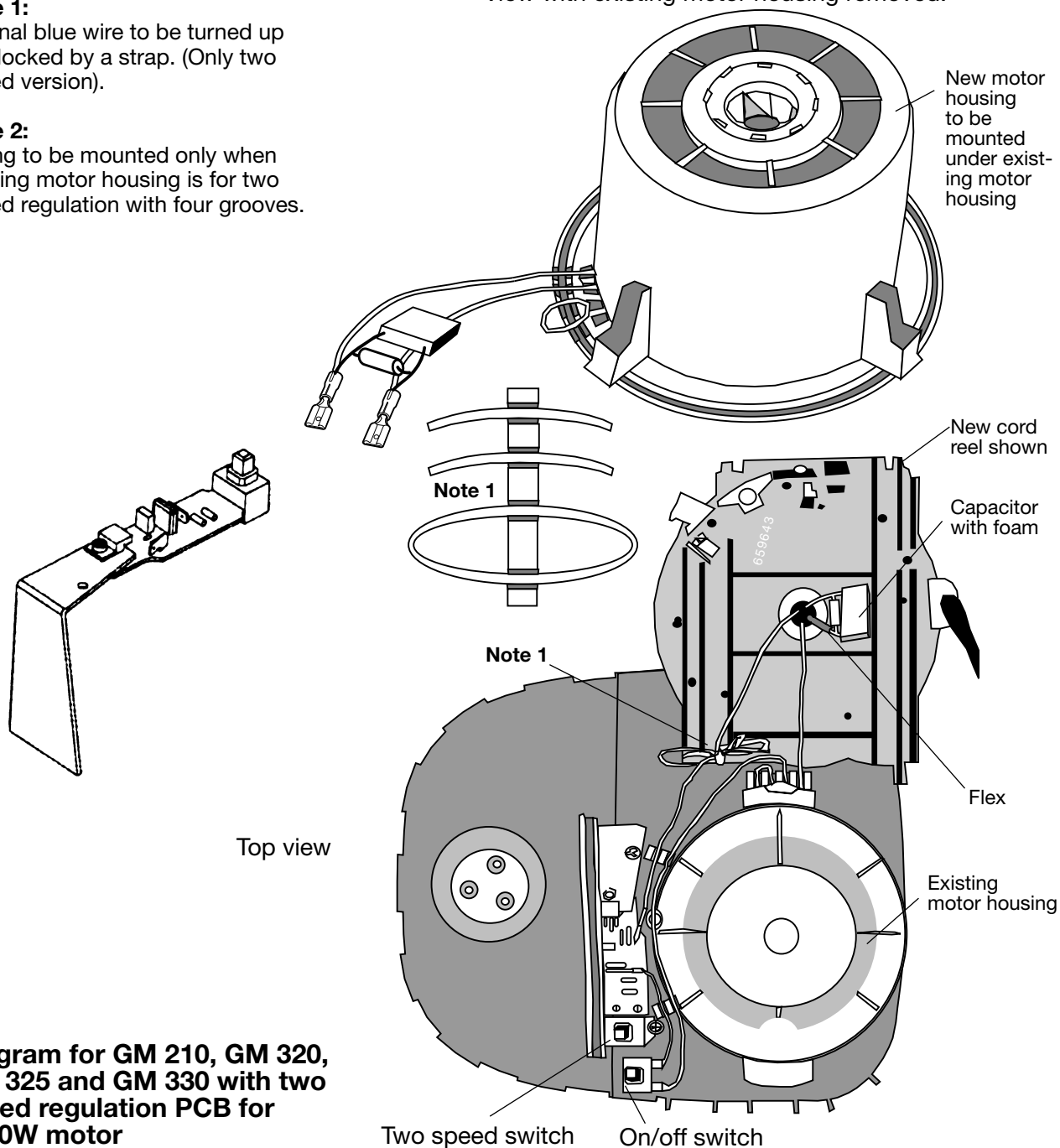
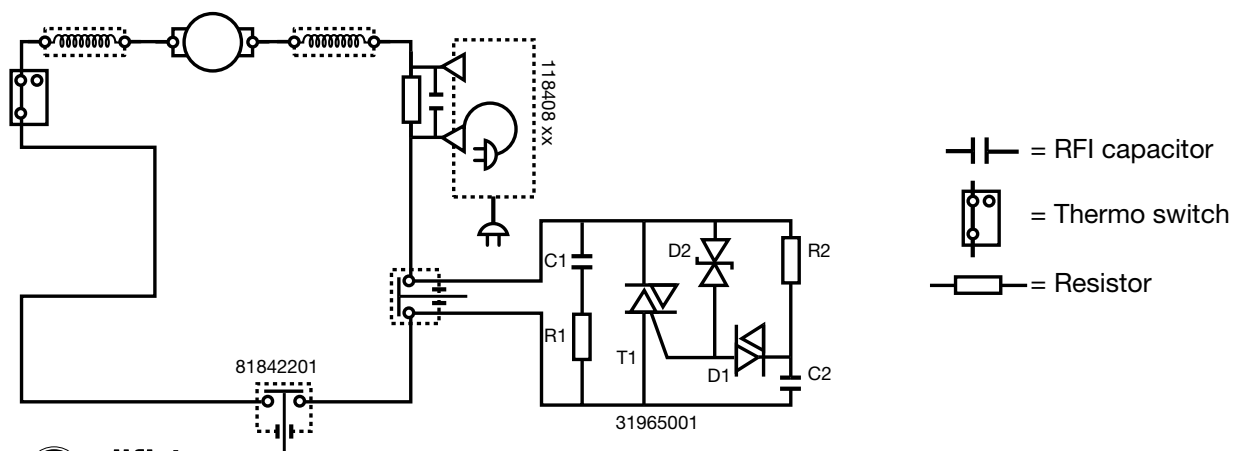

Diagram for GM 210, GM 320, GM 325 and GM 330 with two speed regulation PCB for 1200W motor



## 118408XX. Replacement of the cable reel

## 223526XX. Replacement of the cable reel, King 500 Series

A-0.6.5.

5

**To be performed by a skilled or instructed person !**

**Disconnect the vacuum cleaner from the power supply before starting the work!**

① Models with bag-full indicator: Open the dust cover until it stops and continue with a little pressure by hand until it slides free of the hinges. Models with no bag-full indicator: Open the dust cover and lift it out of the hinges. Remove filter with dust bag. Remove the dust bag holder by pressing bottom clip and ease the holder out of the bottom. This releases the hook at the container wall.

② To separate the top and bottom housing and avoid scratches on the parts, place tool no. 22361400 under the buffer.

Follow instruction 82361500

Remove the strap (12) by hand. Lift up the buffer and remove the top housing.

③ Free the cord with plug from the terminal box in the top housing by using a Pozi screwdriver no. 2 or in old models press it out by hand.

### Remove and replace the cable reel with the internal wires.

The cable reel spring is pre-tightened and this should not be changed so as to avoid damage. Do not unwind the cable and do not tighten the cable additionally.

### Note:

Wire to be wrapped around the post to reduce wire slack before mounting cable reel.

### It is necessary to replace the cord reel button.

Open the accessory cover until it stops and continue with a little pressure by hand until it slides free of the hinges and remove it.

④ Push down the cable release button (a) and press by hand the dust cover button sideways (b) to release it, and lift it up (c).

⑤ Release and remove the side pivots (2) with a pair of pliers (5). To remove the cable reel button (3) and/or the on/off button (4), press the two snaps on the button (d) to release it from the top housing & lift it away after turning it 30 degrees.

Refit in reverse order. Press the buffer back in place by hand after mounting the strap around the housings.

### Testing the cable reel.

Draw the cable out completely and rewind it by pressing the button on top of the machine.

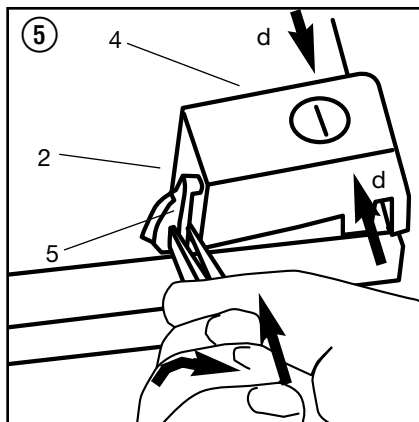
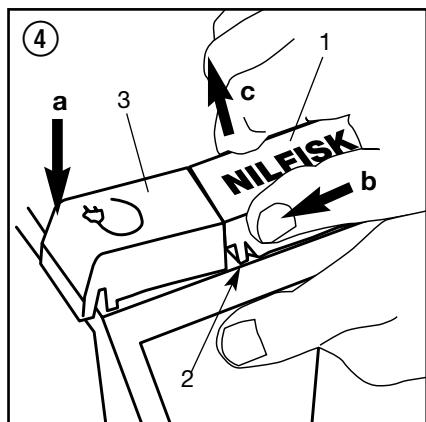
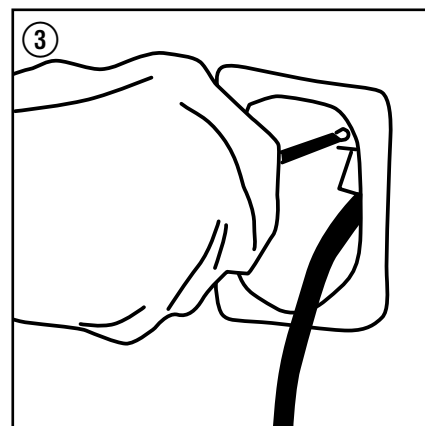
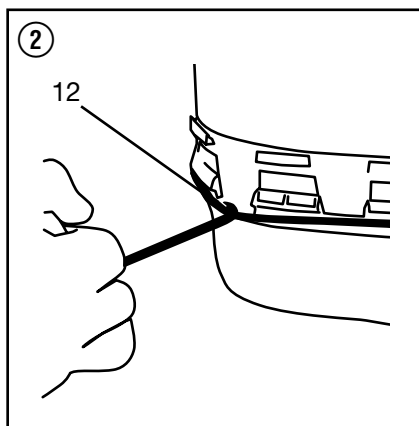
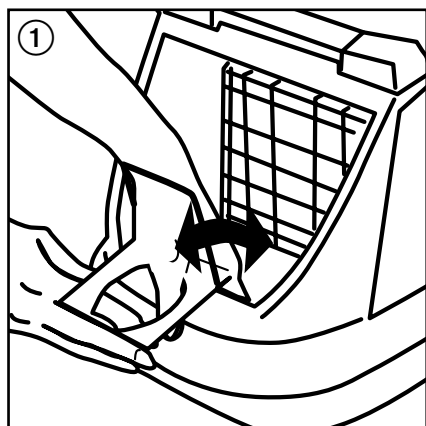

## 118408XX. Replacement of the cable reel

A-0.6.5.

## 223526XX. Replacement of the cable reel, King 500 Series

6

### Top view GM 200/300/400 Series

#### Note 1:

Internal blue wire to be turned up and locked by a strap. (Only two speed version).

#### Note 2:

#### ONLY GM200/300/400 SERIES

O-ring to be mounted only when existing motor housing is for two speed regulation with four grooves.

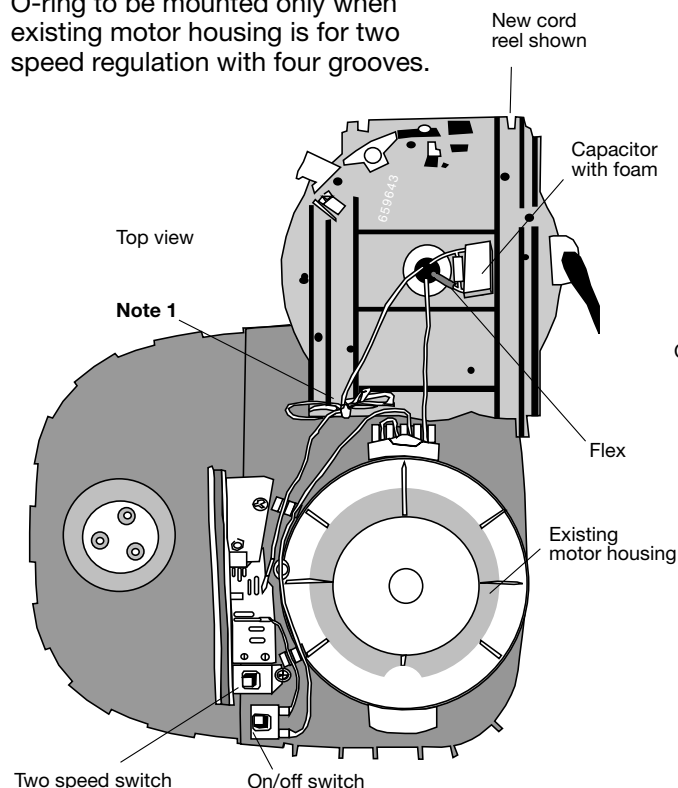

### Top view King 500 Series

#### One Speed

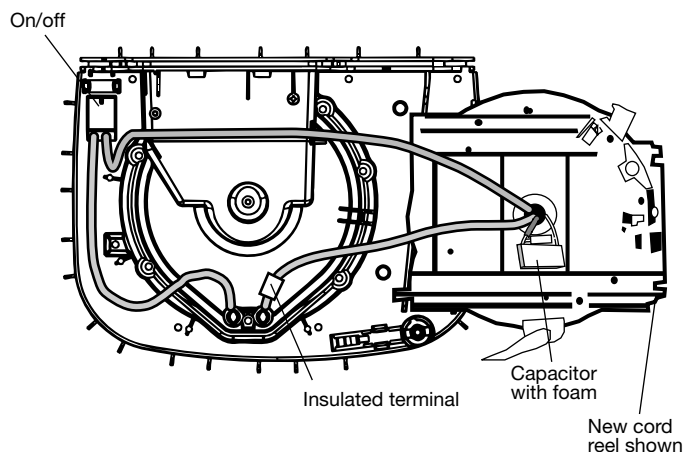

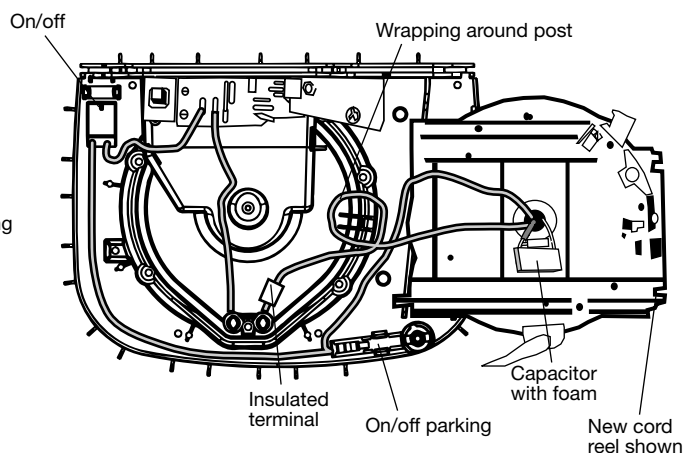

#### Two Speed

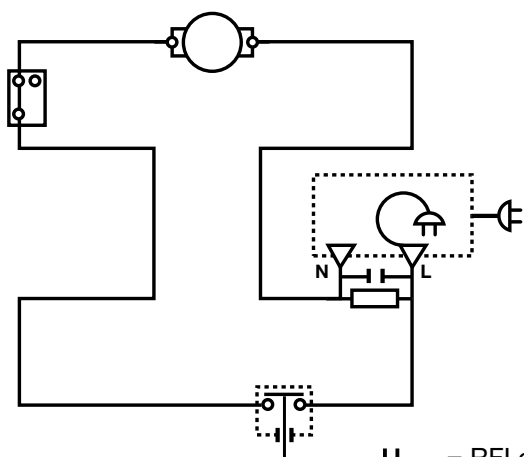

### Diagram for one speed models



 = RFI capacitor  
 = Thermo switch  
 = Resistor

### Diagram for two speed models

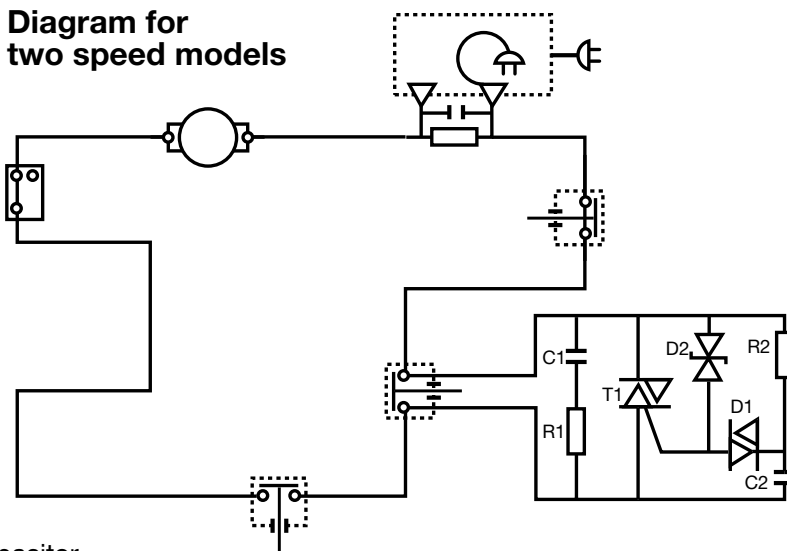

**Assembling of parking clip to the tube**

- ① Mount ring on the tube.
- ② Press bush up on the straight tube until it clicks into the groove marked **0** (the second groove on the telescopic tube). If no click during mounting on the tube, position the bush as shown to fit to the groove.
- ③ Mount the ring on the top of the brush and lock it by turning it counterclockwise.
- ④ To mount parking clip to bush, press hard by hand to snap it into position.

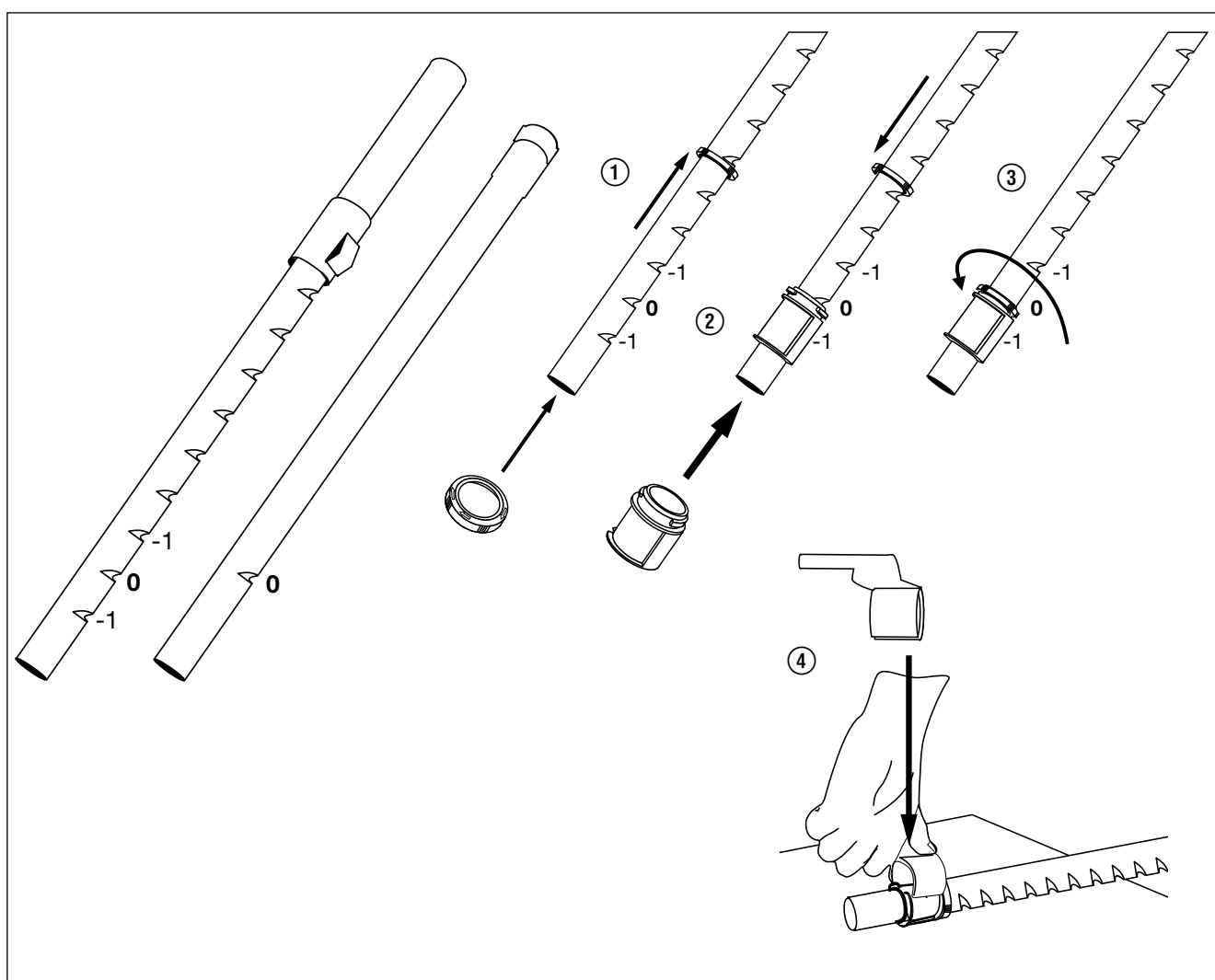

**Parking of tube with nozzle**

- ① Pull the plug free of the cable reel groove.  
Turn nozzle to position foot-plate away from the machine to avoid scratches on the surface and press the parking clip-pin mounted to the tube into the hole inside the cable reel groove.
- ② No parking, when plug is in the cable reel groove.

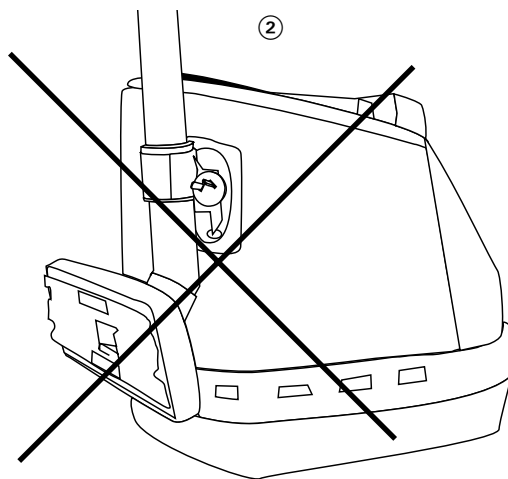
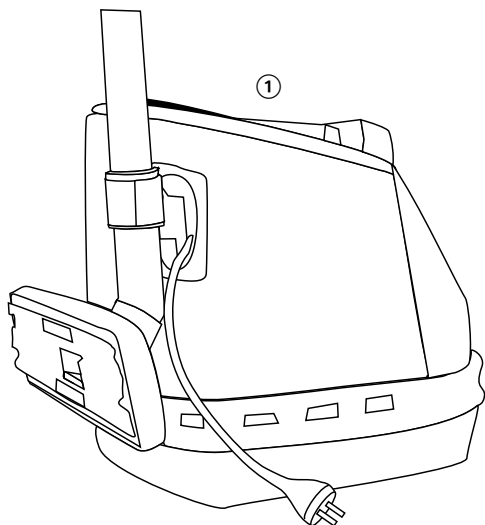



**31965001. Replacement with the two speed PCB for 1200W motor.**

**A-0.6.5.**

**22365700. Replacement of the on/off switch**

**9**

**22354400. Replacement of the on/off switch for parking**

**To be performed by a skilled or instructed person only !**

**Disconnect the vacuum cleaner from the power supply before starting the work!**

1) Models with bag-full indicator: Open the dust cover until it stops and continue with a little pressure by hand until it slides free of the hinges.  
Models with no bag-full indicator: Open the dust cover and lift it out of the hinges.  
Remove filter with dust bag.  
Remove the dust bag holder by pressing bottom clip and ease the holder out of the bottom. This releases the hook at the container wall.

2) To separate the top and bottom housing and avoid scratches on the parts, place tool no. 22361400 under the buffer.  
Follow instruction 82361500

Remove the strap (12) by hand.  
Lift up the buffer and remove the top housing.

3) Free the cord with plug from the terminal box in the top housing by using a Pozi screwdriver no. 2 or in old models press. it out by hand.

#### 4) Remove and replace the On/Off parking switch.

To release the switch, hold the activator pin (5) with one hand and release the switch (6) from the two hooks and pull it away. Leave pin (5) in its position.

Remove and replace the cords to the switch (6).

Replace pin (5) by pushing it downward to give the switch (6) lever access to the hole in the pin (5) and mount the switch (6).

Remove the cord reel and lock the cord to the reel. Remove internal wires and release the on/off switch by pressing a screwdriver under it.  
Remove and replace the new two-speed PCB and/or the on/off switch and connect wires.

**5) NOTE:**  
**GM200/300/400 SERIES ONLY.**  
Bend the terminal pins about 45 degrees

Refit in reverse order. Press the buffer back in place by hand after mounting the strap around the housings.

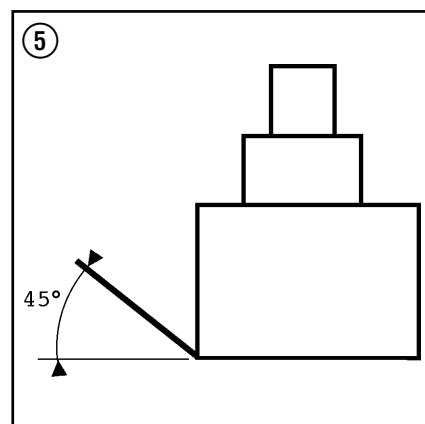
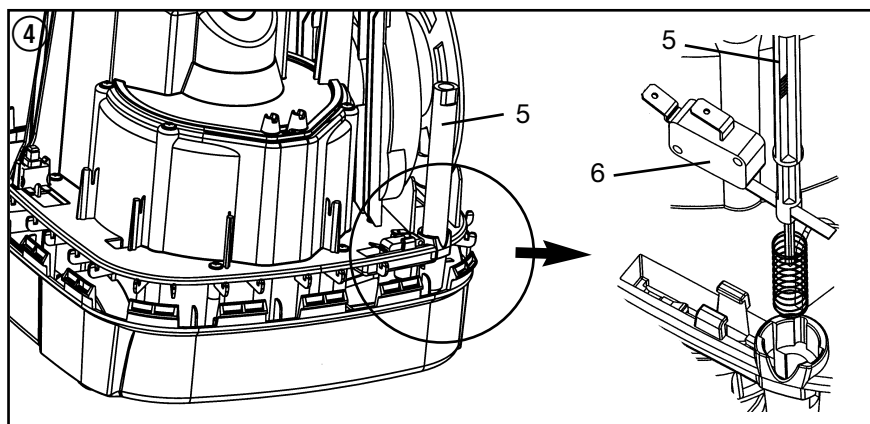
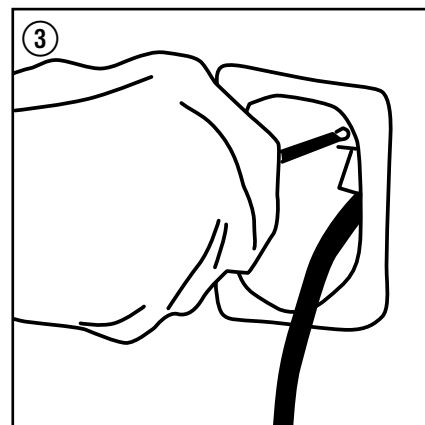
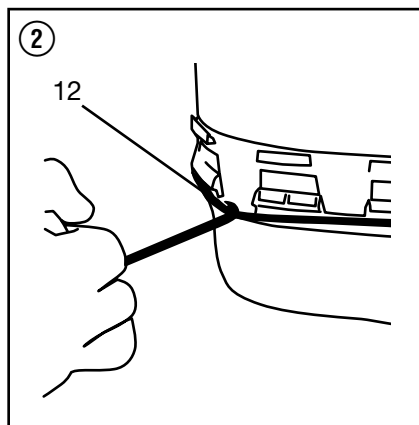
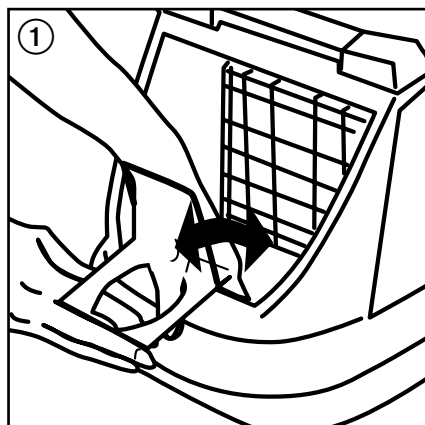

31965001. Replacement with the two speed PCB for 1200W motor.

22365700. Replacement of the on/off switch

22354400. Replacement of the on/off switch for parking

A-0.6.5.

10

## Top view GM 200/300/400 Series

### Note 1:

Internal blue wire to be turned up and locked by a strap. (Only two speed version).

### Note 2:

#### ONLY GM200/300/400 SERIES

O-ring to be mounted only when existing motor housing is for two speed regulation with four grooves.

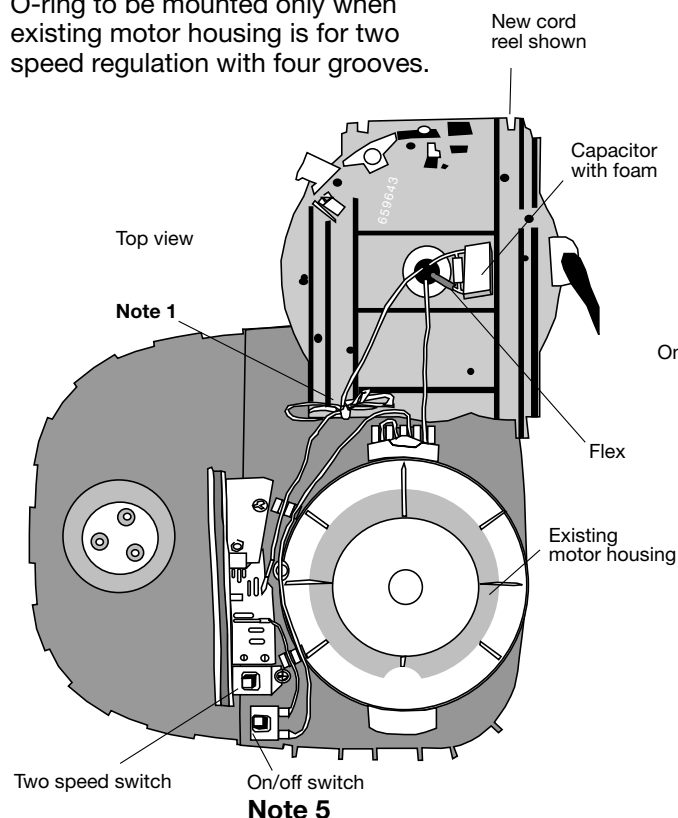

## Top view King 500 Series

### One Speed

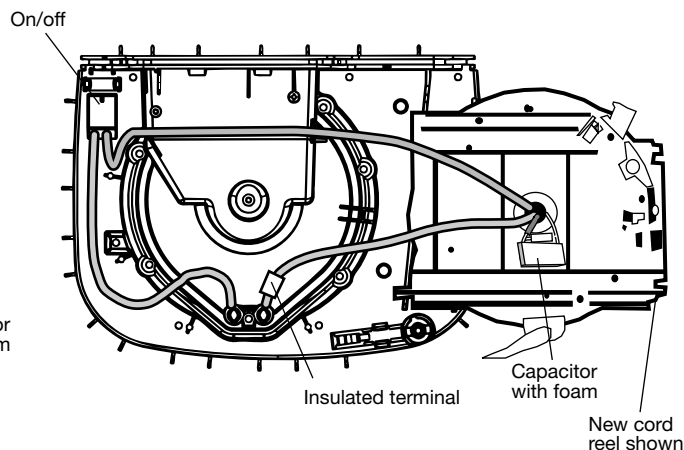

### Two Speed

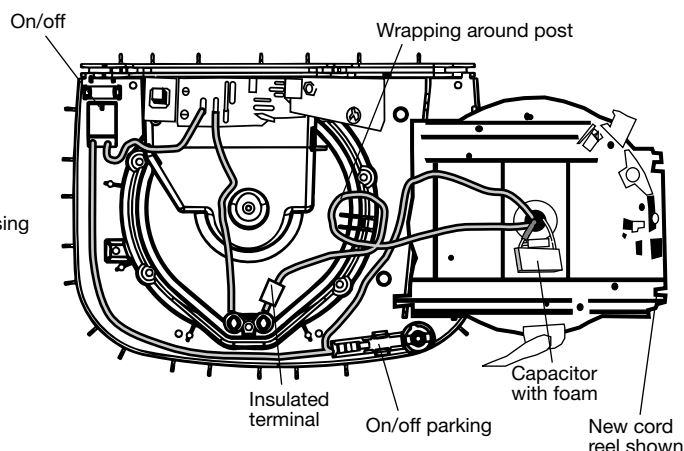

## Diagram for one speed models

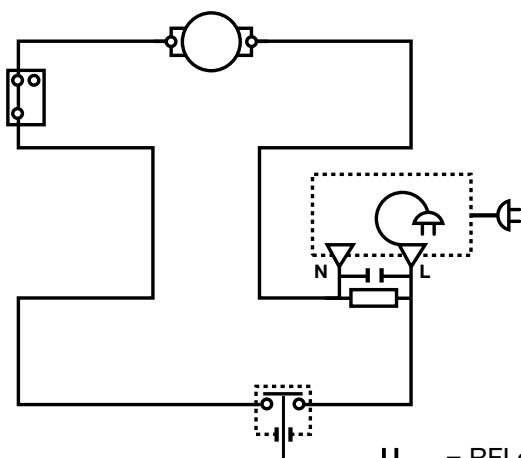

## Diagram for two speed models

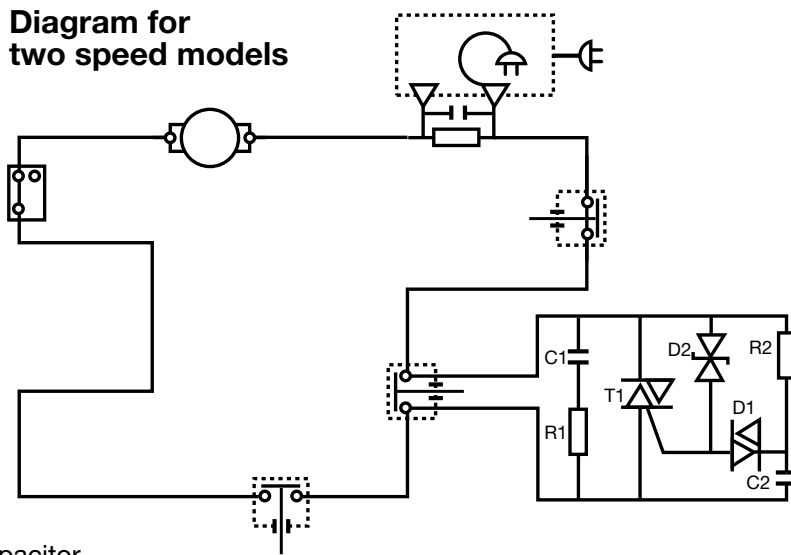

—||— = RFI capacitor

—|— = Thermo switch

—□— = Resistor

## 22201100. Replacement of the thermostatic switch for the new 1200W motor A-0.6.5. 22231100. Replacement of the motor grommets (7) and frame (5)

11

**To be performed by a skilled or instructed person only !**

**Disconnect the vacuum cleaner from the power supply before starting the work!**

① Models with bag-full indicator: Open the dust cover until it stops and continue with a little pressure by hand until it slides free of the hinges.

Models with no bag-full indicator: Open the dust cover and lift it out of the hinges.

Remove filter with dust bag. Remove the dust bag holder by pressing bottom clip and ease the holder out of the bottom. This releases the hook at the container wall.

② To separate the top and bottom housing and avoid scratches on the parts, place tool no. V-33580 under the buffer.

Follow instruction 82361500

Remove the strap by hand or tool no. V 33581. Lift up the buffer and remove the top housing.

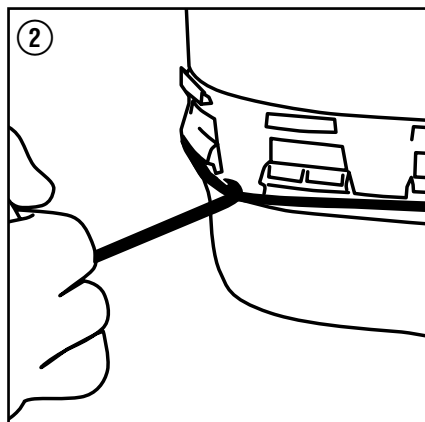
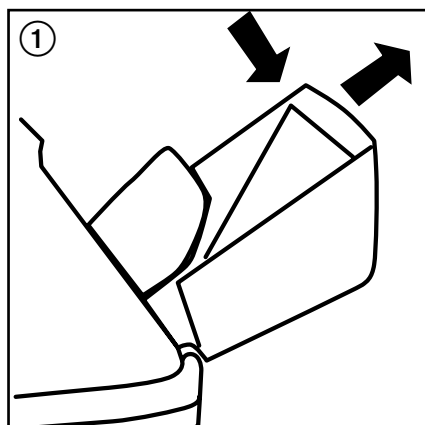

③ Free the cord with plug from the terminal box in the top housing by using a Pozi screwdriver no. 2 or in old models press it out by hand.

Remove the cord reel and lock the cord to the reel. Remove internal wires and release the on/off switch by pressing a screwdriver under it. Remove the motor housing with four screws by a Pozi screwdriver no. 2.

④ Remove the sound suppressor (1) if provided and the cover (2) on the motor housing with four screws (3) and lift out the motor unit (4). Unplug the existing internal wire kit with thermostatic switch mounted in the motor frame (5). Remove the old and replace with the new thermostatic switch and press in place into the slots (6) and press the wires back in the slots on top of the motor frame (5). Refit in reverse order.

Press the buffer back in place by hand after mounting the strap around the housings.

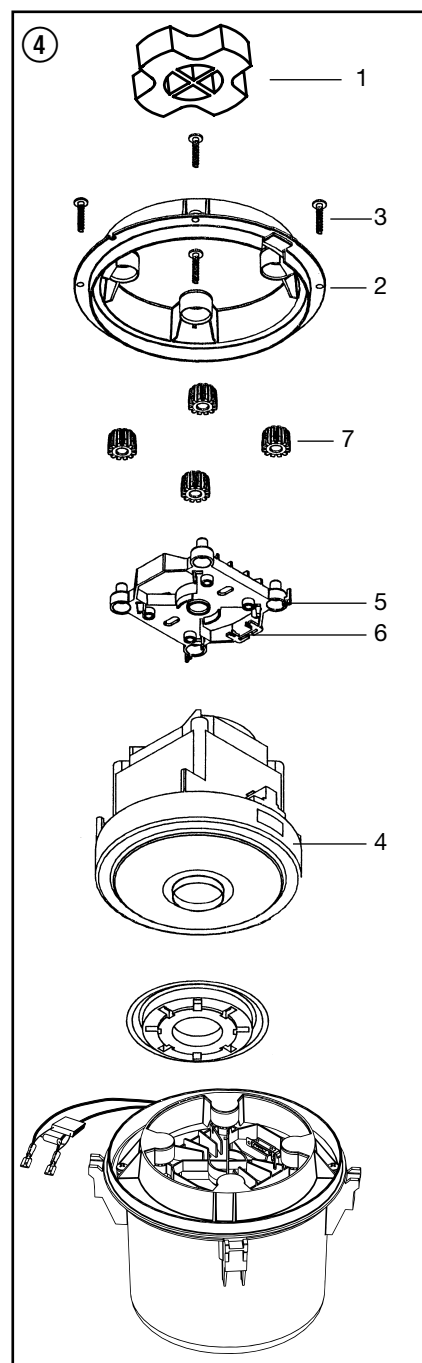
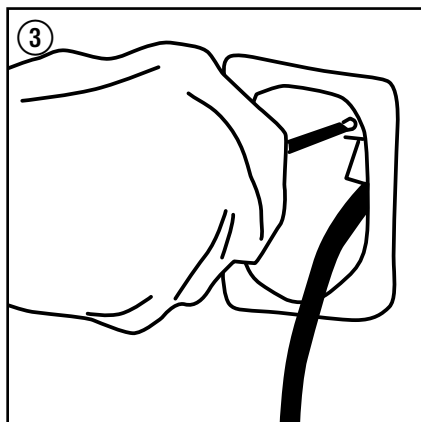
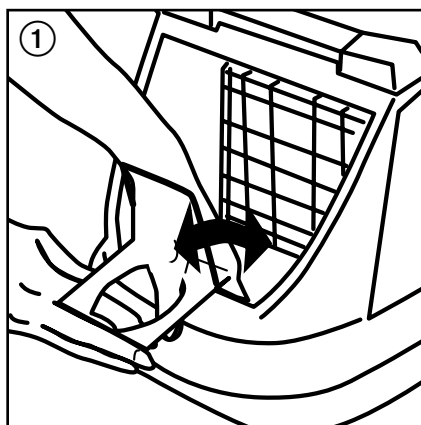

## 22201100. Replacement of the thermostatic switch for the new 1200W motor A-0.6.5. 22231100. Replacement of the motor grommets (7) and frame (5) 12

### Note 1:

Internal blue wire to be turned up and locked by a strap. (Only two speed version).

### Note 2:

O-ring to be mounted only when existing motor housing is for two speed regulation with four grooves.

View with existing motor housing removed.

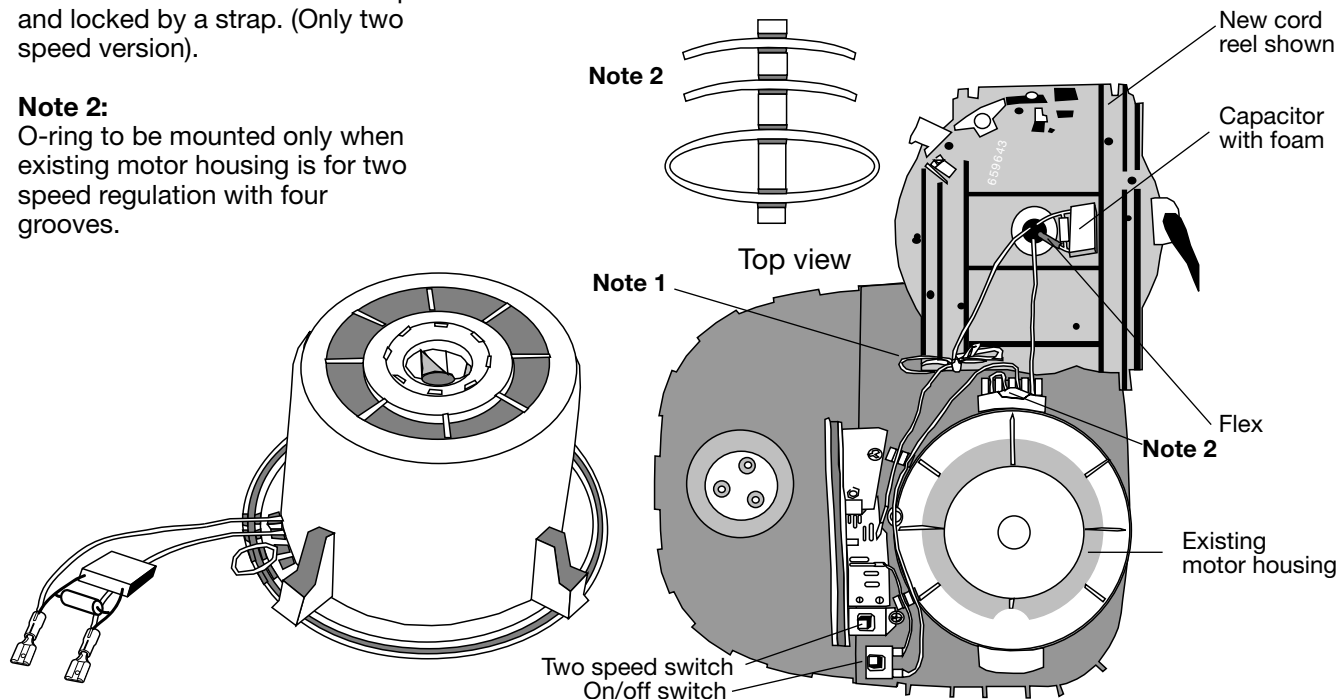

### Diagram for GM 200E/200/300/310/310S

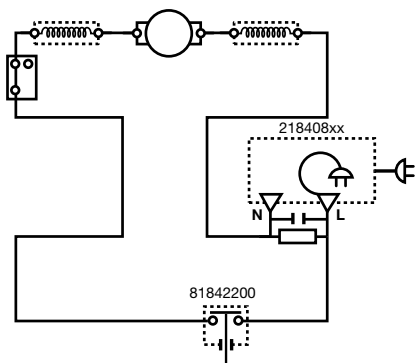

### Diagram for GM 210/320/325/330 with two speed regulation PCB for 1200W motor

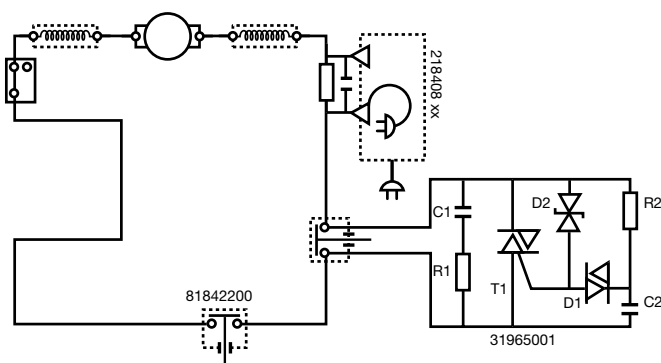

### Diagram for GM 420/425/430 with two speed regulation PCB for 1200W motor and parking on/off switch

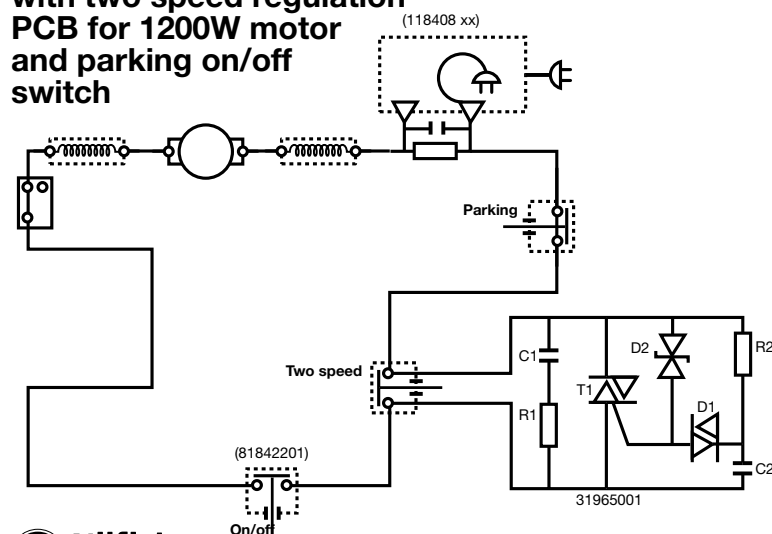

### Symbol explanation

Armature	Field coil	Cord reel
On/off switch	Resistor	Capacitor
Thermo switch		

22226000. Replacement of the buttons for dust cover (1), cable reel (3) and on/off (4)

A-0.6.5

22226300. Replacement of the buttons for two speed regulation (6) and on/off (8)

13

218580xx. Replacement of the top housing (12)

223535xx. Replacement of the top housing King

22352900. Replacement of the On/Off button (4)

22352901. Replacement of the On/Off button two speed (8) with activator (7)

22353100. Replacement of the activator for cord reel

22353200. Replacement of the activator for On/Off

22353900. Replacement of the buttons for dust lid (1), cable reel (3) with pivots (2)

**To be performed by a skilled or instructed person only !**

**Disconnect the vacuum cleaner from the power supply before starting the work!**

## Removal of the dust cover button (1), cable reel button (3) and on/off button (4) for one speed models

Open the accessory cover until it stops and continue with a little pressure by hand until it slides free of the hinges and remove it. Open the dust cover lid.

① Push down the cable release button (a) and press by hand the dust cover button sideways (b) to release it, and lift it up (c).

② Release and remove the side pivots (2) with a pair of pliers (5). To remove the cable reel (3) and/or the on/off button (4), press the two snaps on the button to release it from the top housing & lift it away after turning it 30 degrees.

## ③ How to disassemble the machine

Open the accessory cover until it stops and continue with a little pressure by hand until it slides free of the hinges and remove it.

Models with bag-full indicator: Open the dust cover (9) until it stops and continue with a little pressure by hand until it slides free of the hinges.

Models with no bag-full indicator: Open the dust cover (9) and lift it out of the hinges.

Remove filter with dust bag. Remove the dust bag holder (10) by pressing bottom clip and ease the holder out of the bottom. This releases the hook at the container wall.

To separate the top and bottom housing and avoid scratches on the parts, place tool no. 22361400 (11) under the buffer.

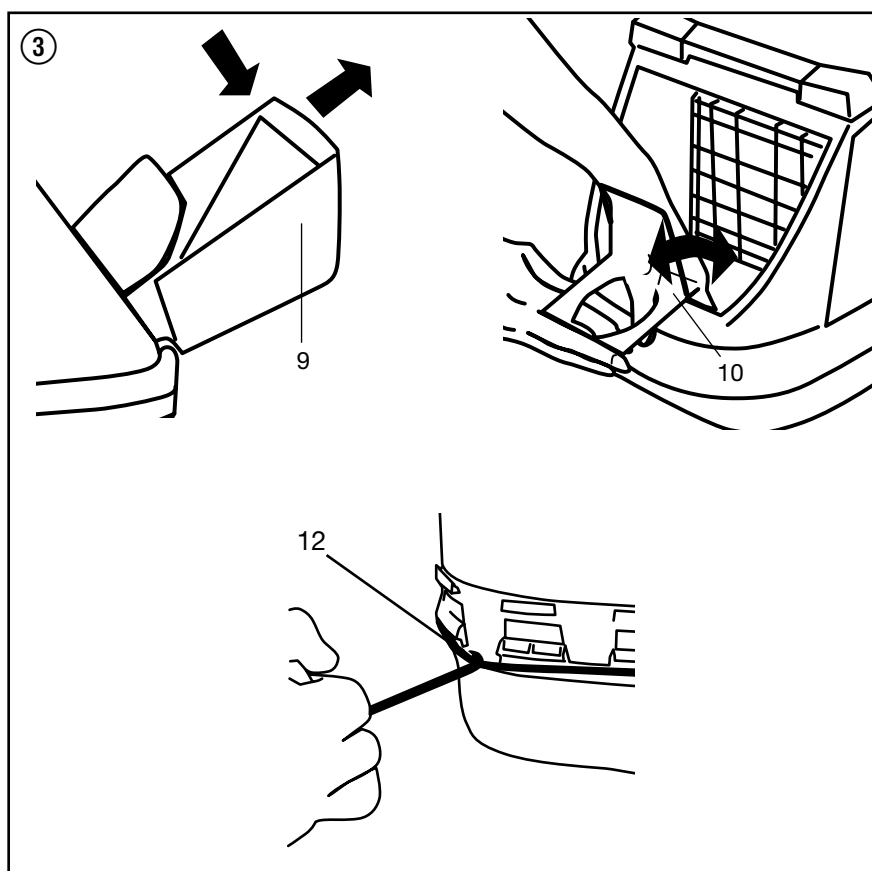
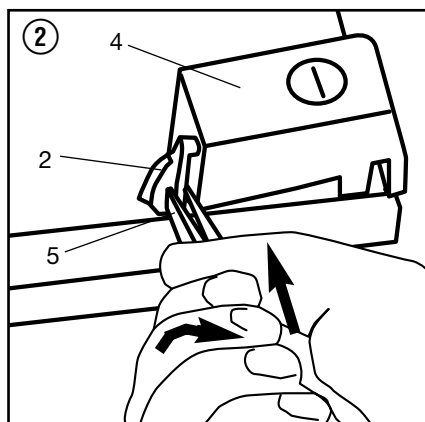
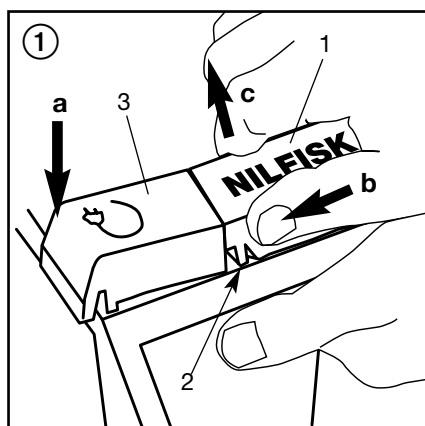

22226000. Replacement of the buttons for dust cover (1), cable reel (3) and on/off (4)

A-0.6.5

22226300. Replacement of the buttons for two speed regulation (6) and on/off (8)

14

218580xx. Replacement of the top housing (12)

223535xx. Replacement of the top housing King

22352900. Replacement of the On/Off button (4)

22352901. Replacement of the On/Off button two speed (8) with activator (7)

22353100. Replacement of the activator for cord reel

22353200. Replacement of the activator for On/Off

22353900. Replacement of the buttons for dust lid (1), cable reel (3) with pivots (2)

## ④ Removal of the two speed regulation button (6) and/or the on/off button (8) for two speed regulation models, and/or the activators.

Press a screwdriver into the inside bush (7) of the two speed regulation button, turn it clock-wise 90 degree and pull it away. Remove the button (6) with the spiral spring.

*Removal of the on/off button (8):*

Remove the two-speed regulation button (6) as described.

Press the two snaps on the button (8) to release it from the top housing and lift it away after turning it 30 degrees.

## Replacement of the top housing

Remove dustcover button, cable reel button and on/off button.

Remove cable terminal and screw, retainer, ratches and handle accessory lid, see instruction 82362400.

Remove activator for cord reel (20, 21, 22). Remount buttons, cable terminal, retainer, accessory lid and activator for cord reel, etc. on new upper part.

## Reassembly machine

Press the buffer in place by hand after mounting the strap (12) around the housings.

## Replace in reverse order.

## All models: Test after repair

After repair, please check that the vacuum cleaner is functioning to Nilfisk specifications and any local authorised precautions.

Removal of the on/off activator:  
Snap off, break, activator for on/off button (23, 24, 25, 26).  
Replace with new parts.

## Tool to be used for:

Two speed regulation button (6)

Side pivot (2)

## Tool type

Sloth screwdriver 3,5mm

Pair of pliers (5)

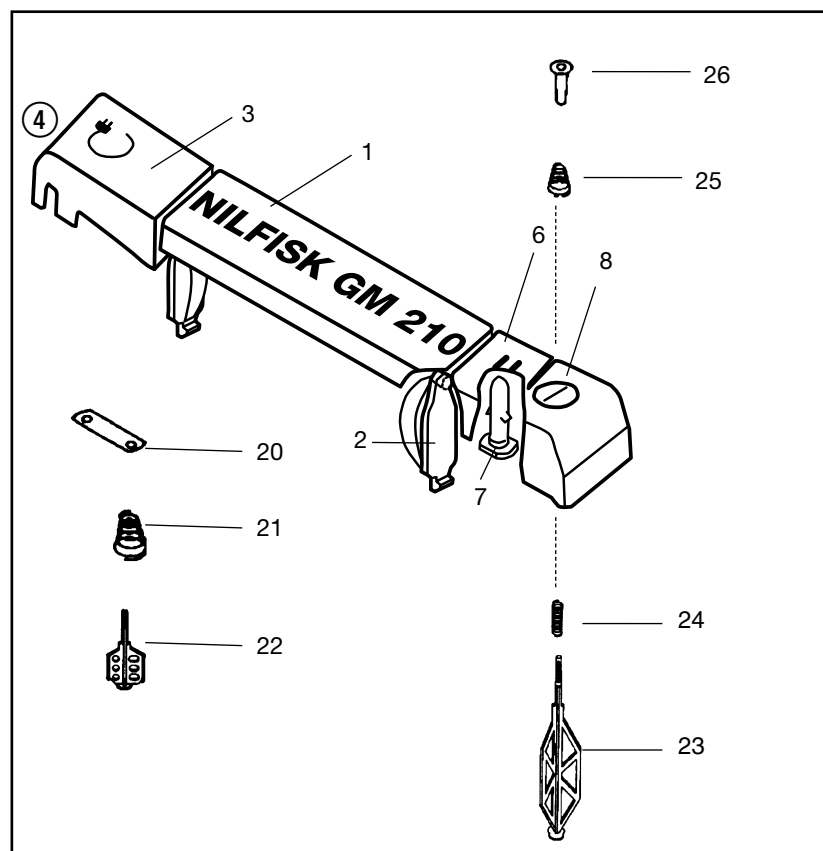

## 22361200. Replacing the pair of ratchet for dust cover

A-0.6.5  
15

**To be performed by a skilled or instructed person only !**

### Converting from black ratchet to the dark grey version

① Open the accessory cover until it stops and continue with a little pressure by hand until it slides free of the hinges and remove it. Open the dust cover lid.

② Push down the cable release button (a) and press by hand the dust cover button sideways (b) to release it, and lift it up (c).

③ Unscrew the two screws with a screwdriver type Pozidrive no.2 and remove with the steel plate.

④⑤ Remove the two ratchets from the spring and replace the two dark grey versions into the spring.

⑥ When replacing the steel plate be sure that the hooks on the ratchets in both sides are in mesh with hole in the steel plate.

Press down the steel plate and replace the two screws with adequate force.

To replace the dust cover button, push down the cable release button and press it by hand sideways to fit the two tabs.

Replace the accessory cover and lock the dust cover.

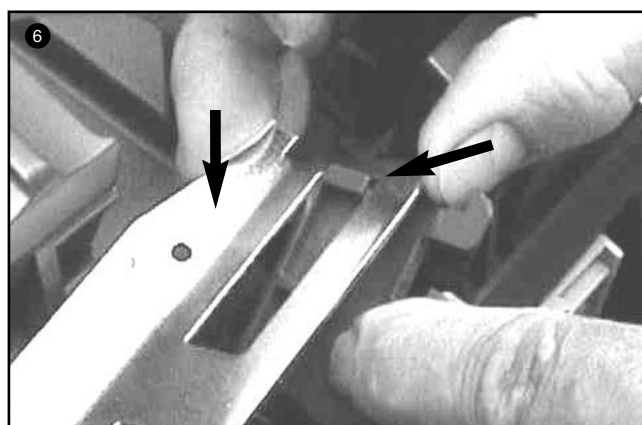
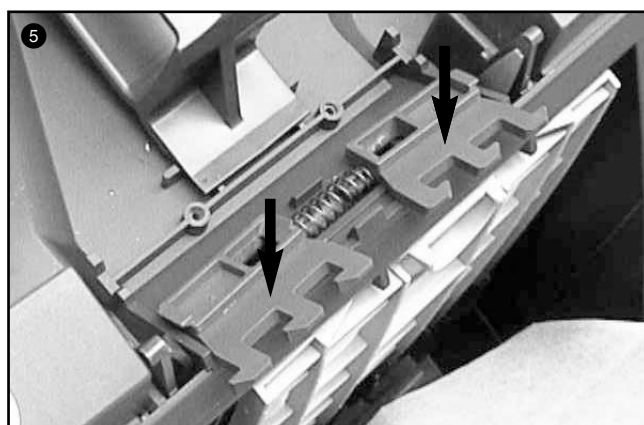
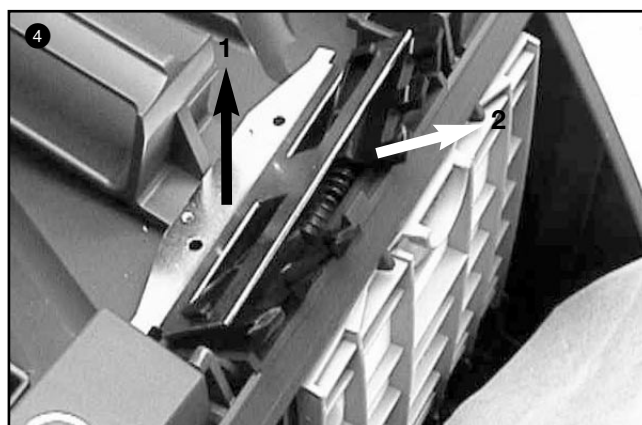
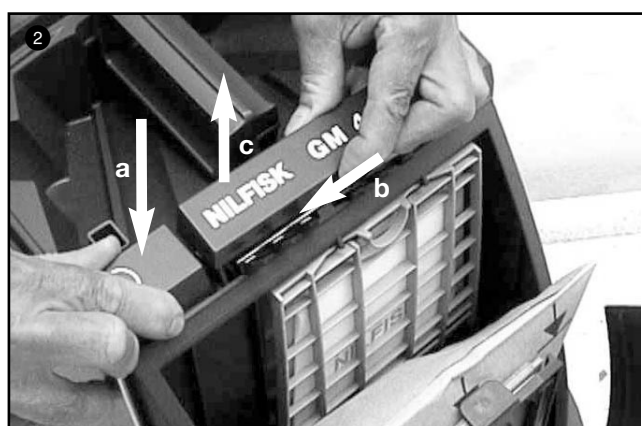
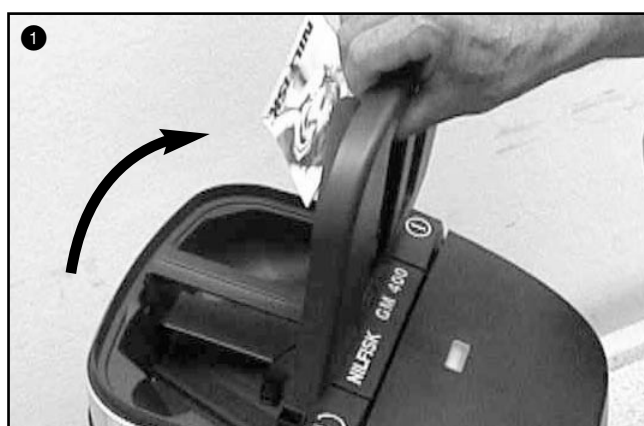





## 22352800. Replacement of the rear wheels

A-0.6.5.

17

**To be performed by a skilled or instructed person only !**

**Disconnect the vacuum cleaner from the power supply before starting the work!**

① Models with bag-full indicator: Open the dust cover until it stops and continue with a little pressure by hand until it slides free of the hinges.

Models with no bag-full indicator: Open the dust cover and lift it out of the hinges.

Remove filter with dust bag. Remove the dust bag holder by pressing bottom clip and ease the holder out of the bottom. This releases the hook at the container wall.

② To separate the top and bottom housing and avoid scratches on the parts, place tool no. 22361400 under the buffer.

Follow instruction 82361500.

Remove the strap by hand or tool no. V 33581. Lift up the buffer and remove the top housing.

③ Free the cord with plug from the terminal box in the top housing by using a Pozi screwdriver no. 2. Lift away the upper housing.

Remove the cord reel and lock the cord to the reel.

Unscrew from top the screw for the wheel with a Torx T 20 screwdriver and remove the shaft with wheel from the bottom side.

Mount the new wheel with shaft by the use of a small screwdriver and a Torx T 20 screwdriver.

Mount shaft into wheel and place a small screwdriver through the hole for the metric screw. Push wheel with shaft and a small screwdriver into the groove for wheel from the bottom side with small screwdriver pointing through the metric hole. When screw is positioned from the upper side, the screw will push out the small bottom screwdriver.

Replace cords reel and lift the upper housing back on top of the bottom housing. Press the buffer in place by hand after mounting the strap around the housings.

Replace the accessory cover and lock the dust cover.

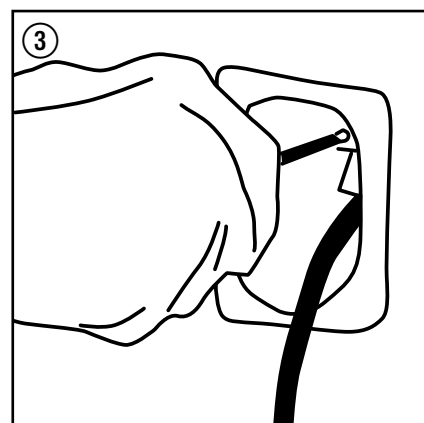
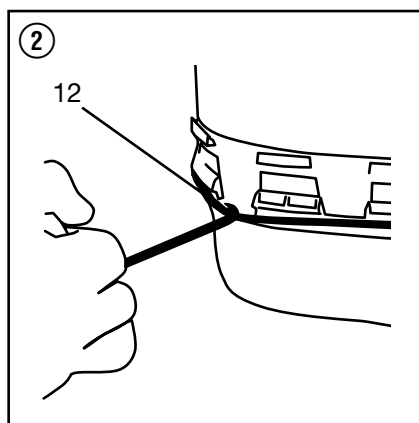
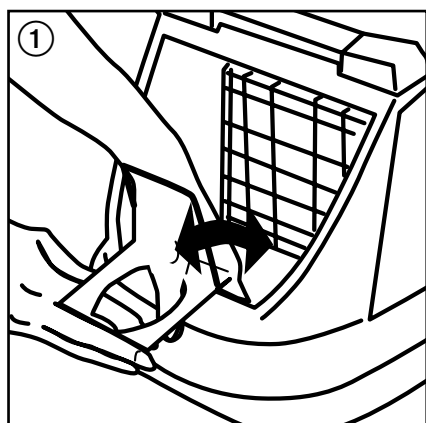

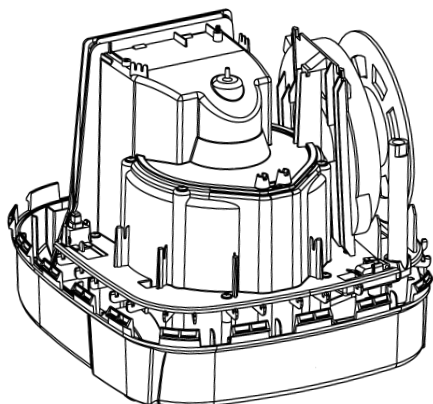

## One Speed

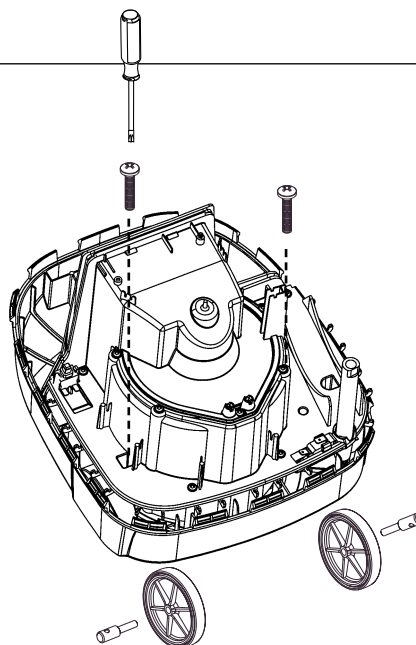

## Two Speed

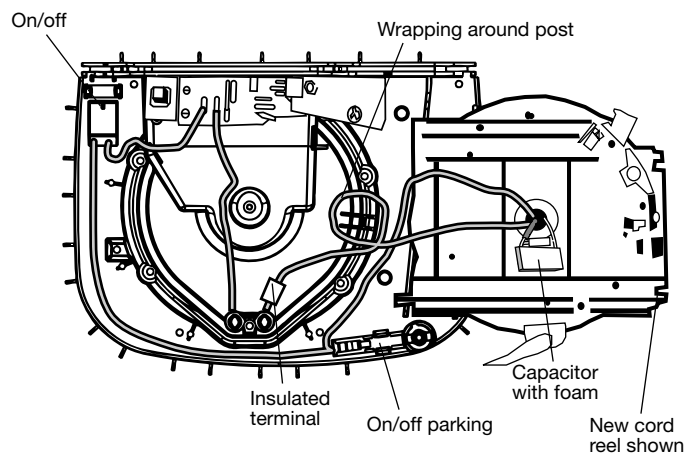
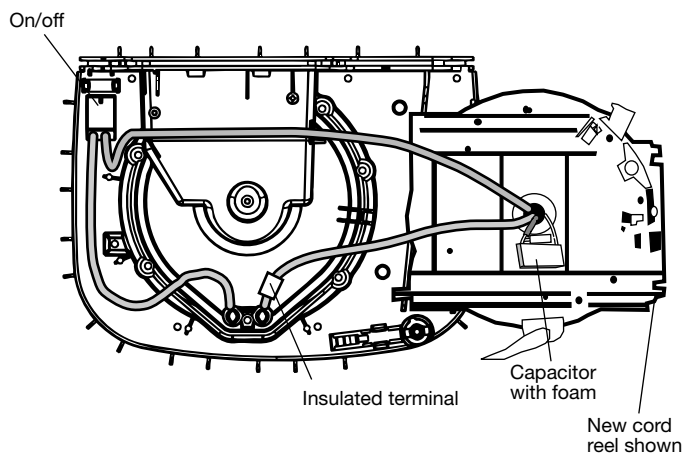

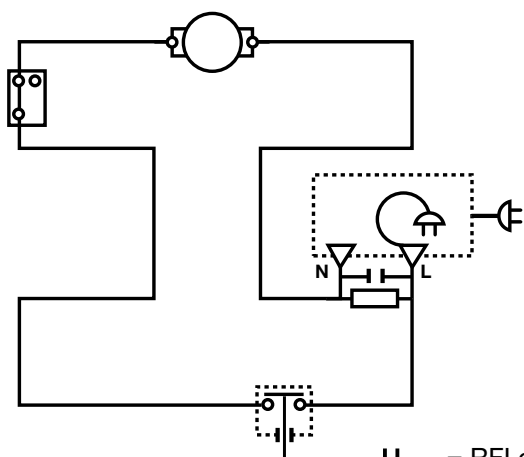

### Diagram for one speed models

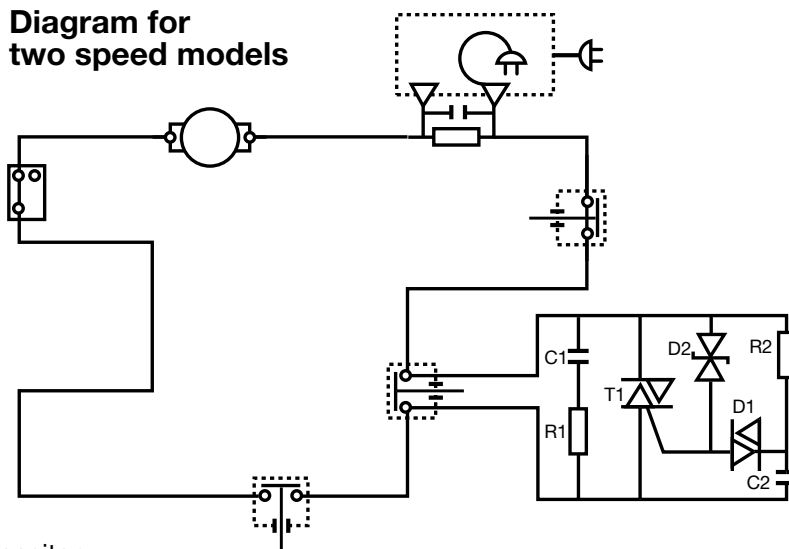

### Diagram for two speed models



-  = RFI capacitor  
 = Thermo switch  
 = Resistor

## 22353000. Replacing the dust lid retainer parts & black handle

A-0.6.5

## 22353300. Replacing the accessory lid

19

## 22353400. Replacing the cable terminal and screw

## 22353600. Replacing the dust cover with indicator

## 22353700. Replacing the dust cover without indicator

## 22354500. Replacing the front filter frame

**To be performed by a skilled or instructed person only !**

**Disconnect the vacuum cleaner from the power supply before starting the work!**

### Replacement of the dust cover, 22353600, 22353700:

With indicator- Open the dust cover until it stops and continue with a little pressure by hand until it slides free of the hinges.

Without indicator- Open the dust cover until it slides free of the hinges.

Replace in reverse order.

### Replacement of the front filter frame, 22354500:

Open the dust cover and remove the dust bag and front filter. Remove the frame by lifting it away from the four brackets. When replacing it must snap back in four places.

Replace in reverse order.

### Replacement of the cable terminal and screw, 22353400:

Pull out the plug and unscrew the screw with a Pozi drive screwdriver no.2 and remove the cable terminal by guiding the cord through the slot in it.

Replace in reverse order.

### Replacement of the accessory lid, 22353300:

Open the accessories lid to vertical position and pull it away.

Release the hinge tube snap with a screwdriver and slide out the part.

Replace the new hinge tube by sliding it back until it clicks into position.

Replace in reverse order.

### Replacement of the dust lid retainer parts & black handle, 22353000:

① Open the accessory lid until it stops and continue with a little pressure by hand until it slides free of the hinges and remove it. Open the dust cover.

② Push down the cable release

button (a) and press by hand the dust cover button sideways (b) and up (c) to release it.

③ Unscrew the two screws with a screwdriver type Pozidrive no.2 and remove with the steel plate. Now the black handle can be replaced.

④⑤ Remove the two ratchets from the spring and replace the two dark grey versions into the spring.

Remove and replace the black handle

⑥ When replacing the steel plate be sure that the hooks on the ratchets in both sides are in mesh with hole in the steel plate.

Press down the steel plate and replace the two screws with adequate force.

To replace the dust cover button, push down the cable release button and press it by hand sideways to fit the two tabs.

Replace the accessory lid and lock the dust cover.

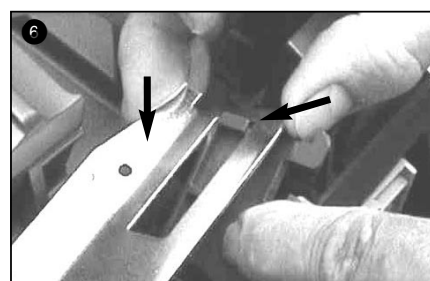
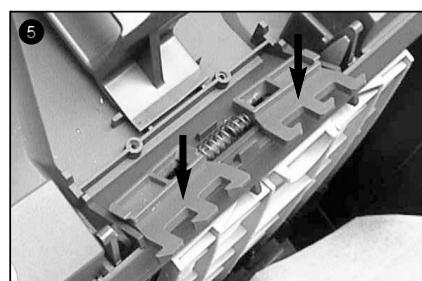
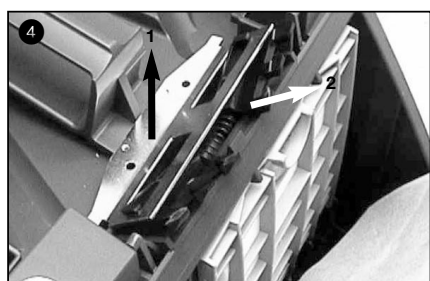
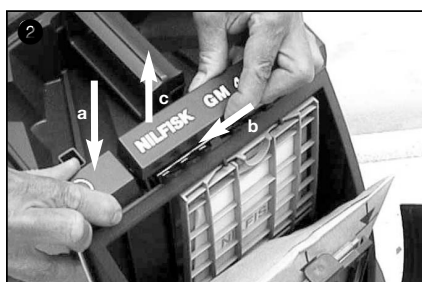
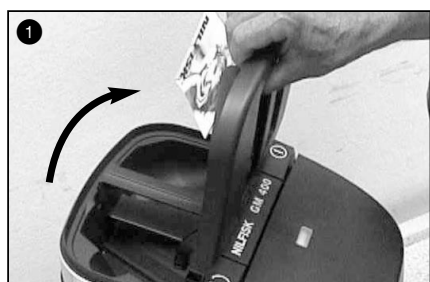



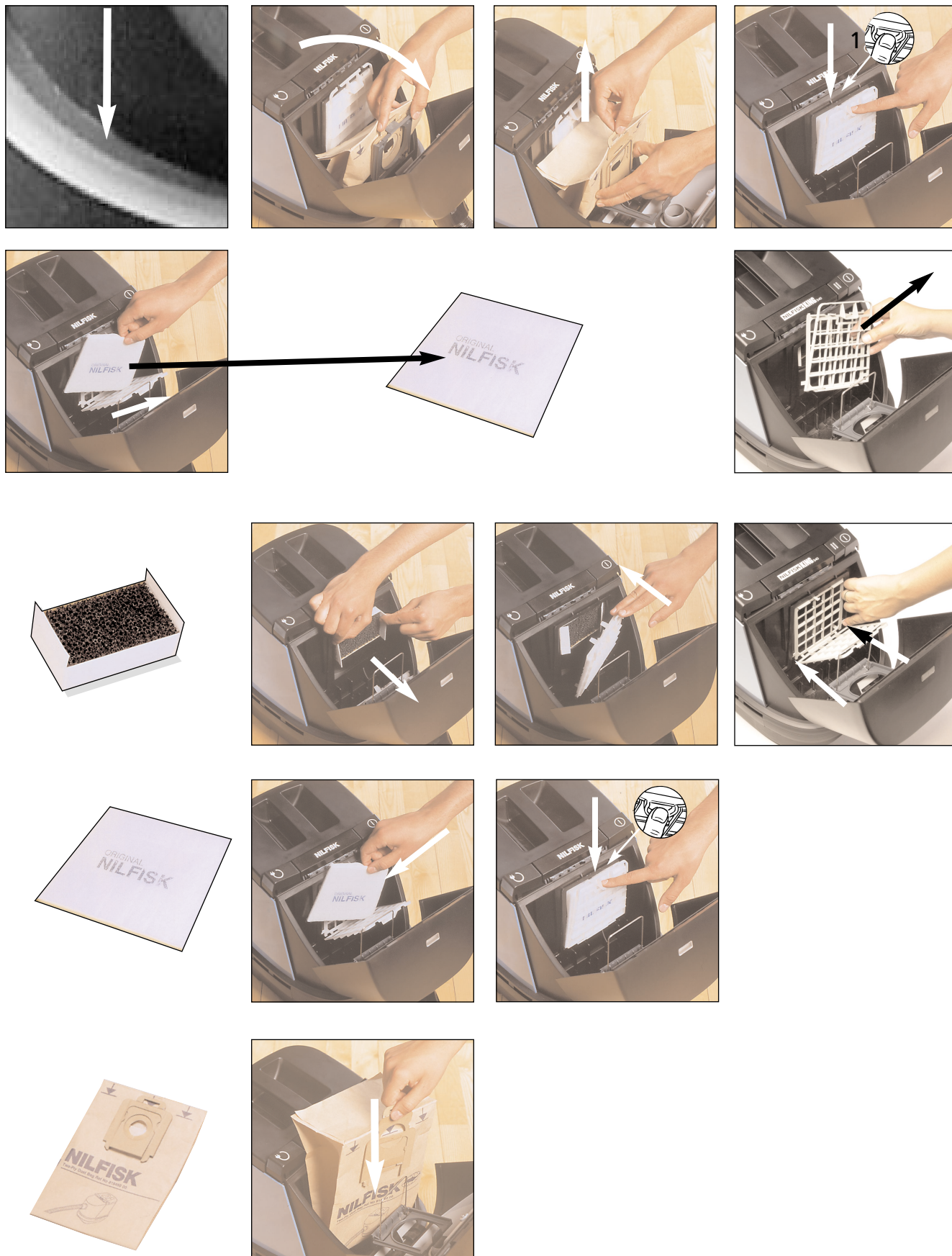



## 22353800. Replacing the front hinge for dust cover 22354200. Replacing the Bottom part 22354300. Replacing the Gaskets for suction house

A-0.6.5

23

**To be performed by a skilled or instructed person only !**

**Disconnect the vacuum cleaner from the power supply before starting the work!**

① Models with bag-full indicator: Open the dust cover until it stops and continue with a little pressure by hand until it slides free of the hinges. Models with no bag-full indicator: Open the dust cover and lift it out of the hinges. Remove filter with dust bag. Remove the dust bag holder by pressing bottom clip and ease the holder out of the bottom. This releases the hook at the container wall.

② To separate the top and bottom housing and avoid scratches on the parts, place tool no. 22361400 under the buffer.

Follow instruction 82361500

Remove the strap (12) by hand or tool no. V 33581. Lift up the buffer and remove the top housing.

### Removal and replace of the front hinge, 22353800

Disassemble the machine. Lift-up the buffer(13) by hand. Remove the hinge with a flat-headed screwdriver by pressing at the snap lock and pull away the hinge. Refit in reverse order.

### ④ Removal and replace of the bottom part, 22354200

Disassemble the machine. Lift-up the buffer(13) and remove the strap(12) by hand and lift away the bottom part. Loosen the four screws (16) for the HEPA filter in the bottom housing by turning them through 90 degrees using a coin (17). Pull out the tube (18) with your finger tips. Unscrew the five screws (10) in the bottom to release it from the suction house. Remove the cord reel. Unscrew from top the two screws (11) for the wheel with a Torx T 20 screwdriver and remove the shaft with wheel from the bottom side. Mount the wheel into the new bottom with shaft by the use of a small screwdriver and a Torx T 20 screwdriver. Mount shaft into wheel and place a small screwdriver through the hole for the metric screw. Push wheel

with shaft and a small screwdriver into the groove for wheel from the bottom side with small screwdriver pointing through the metric hole. When screw is positioned from the upper side, the screw will push out the small bottom screwdriver. Remove the two front hinges. Refit in reverse order.

### Removal and replace of the Gaskets for suction house, 22354300

Disassemble the machine. Lift-up the buffer (13) and remove the strap (12) by hand and lift away the bottom part. Loosen the four screws (16) for the HEPA filter in the bottom housing by turning them through 90 degrees using a coin (17). Pull out the tube (18) with your finger tips. Unscrew the five screws(10) in the bottom to release it from the suction house and replace the two gaskets(14-15). Refit in reverse order.

### Assembling of the machine.

Position the upper part on the bottom part, replace the strap(12) between the hooks and press by hand the buffer(13) until it snaps the two parts together

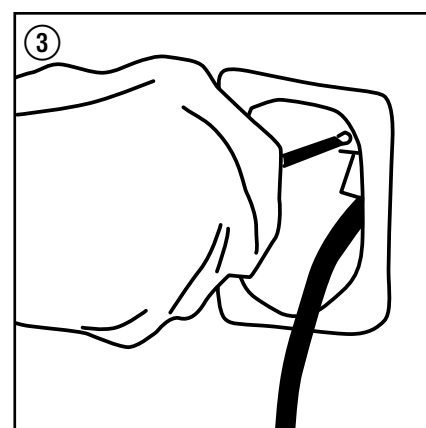
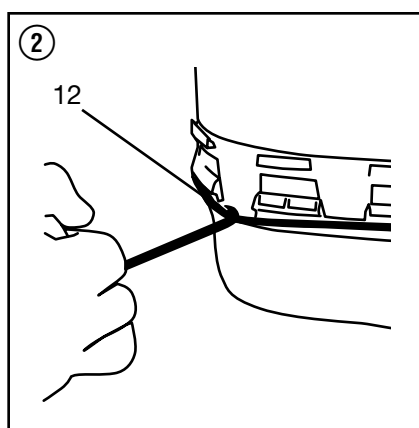
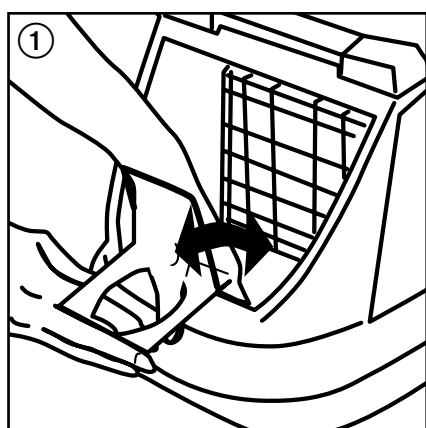

22353800. Replacing the front hinge for dust cover  
22354200. Replacing the Bottom part  
22354300. Replacing the Gaskets for suction house

A-0.6.5  
24

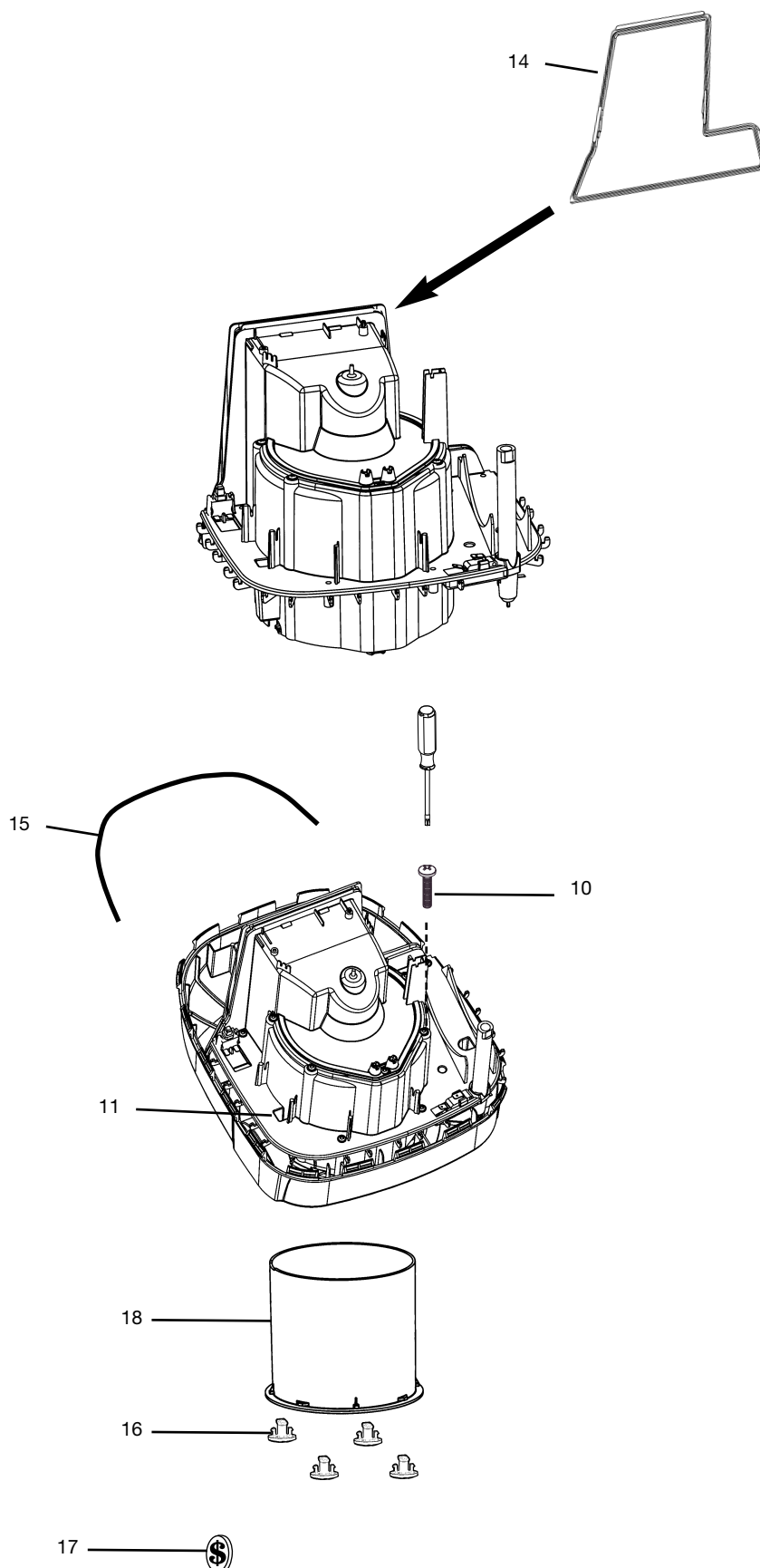



**22352200. Replacing the Motor/Fan unit**

**A-0.6.5**

**22352400. Replacing the internal wires for one speed motor**

**25**

**22352500. Replacing the internal wires for two speed motor**

**22352700. Replacing the Motor suspension**

**22354000. Replacing the Motor tube**

**22354100. Replacing the suction house**

**To be performed by a skilled or instructed person only !**

**Disconnect the vacuum cleaner from the power supply before starting the work!**

**Follow instruction 82362200 first 1,2,3**

**How to disassemble the machine.**

Loosen the four screws (16) for the HEPA filter in the bottom housing by turning them through 90 degrees using a coin (17). Pull out the tube (18) with your fingertips. To separate the top and bottom housing and avoid scratches on the parts, place tool no. 22361400 under the buffer.

Follow instruction 82361500

Remove the strap by hand and lift away the top housing.

**Replacing the motor/fan unit 22352200.**

**Replacing the motor suspension 22352700.**

**Replacing the motor tube 22354000.**

Disassemble the machine. Remove the wires from the two terminal spades (23) and press down to free them from the rubber gaskets, unscrew the six screws (22) from top and pull out the motor tube (20) with the two red internal wires.

Remove and replace the motor/fan (25) unit with rubber suspension (27-28-29-30) and/or internal red wires.

When replacing the internal wires wrap them around the two small fixtures (32) on the motor suspension (28). When replacing with new motor suspension parts, press by hand to click item 27 & 28 together (29), before mounting onto the motor/fan unit.

Before replacing the motor tube (20), place the two-rubber gaskets (26) with the slots in opposite position and with the terminal spades (23) pulled back into the rubber gaskets (26).

Replace the motor/fan unit (25) with the bow tie formed motor suspension (29) turned to fit to the same form (31) in the bottom of the tube (20). Mount the motor tube (20) unit with internal red wires to the suction house (19) with the six screws (22).

Replace the internal wires according to wiring diagram. Refit in reverse order.

**Removal and replacement of the suction house (19), 22354100**

Disassemble the machine.

Unscrew from top the screw (11) for the wheel with a Torx T 20 screwdriver and remove the shaft with wheel from the bottom side. Unscrew the five screws (10) in the bottom to release it from the suction house (19) and replace the gasket (15) on the new suction house(19).

Unscrew the six screws (22) from top and pull out the motor tube (20) with the two internal wires. Be sure to remember the upper motor suspension (30).

**Remove and replace the On/Off parking switch.**

To release the switch, hold the activator pin (7) with one hand and release the switch (8) from the two hooks and pull it away. Remove and replace the pin (7) with spring into the bush of the housing.

Remove and replace the cords to the switch (8).

Replace pin (7) by pushing it downward to give the switch (8) lever access to the hole in the pin (7) and mount the switch (8).

Remove and replace the On/Off switch, Two speed PCB and internal wires (5-6).

Mount the wheel with shaft by the use of a small screwdriver and a Torx T 20 screwdriver.

Mount shaft into wheel and place a small screwdriver through the hole for the metric screw. Push wheel with shaft and a small screwdriver into the groove for wheel from the bottom side with small screwdriver pointing through the metric hole. When screw (11) is positioned from the upper side, the screw (11) will push out the small bottom screwdriver.

Refit in reverse order.

**Assembling of the machine**

Position the upper part on the bottom part, replace the strap (12) between the hooks and press by hand the buffer (13) until it snaps the two parts together.

22352200. Replacing the Motor/Fan unit

A-0.6.5

22352400. Replacing the internal wires for one speed motor

26

22352500. Replacing the internal wires for two speed motor

22352700. Replacing the Motor suspension

22354000. Replacing the Motor tube

22354100. Replacing the suction house

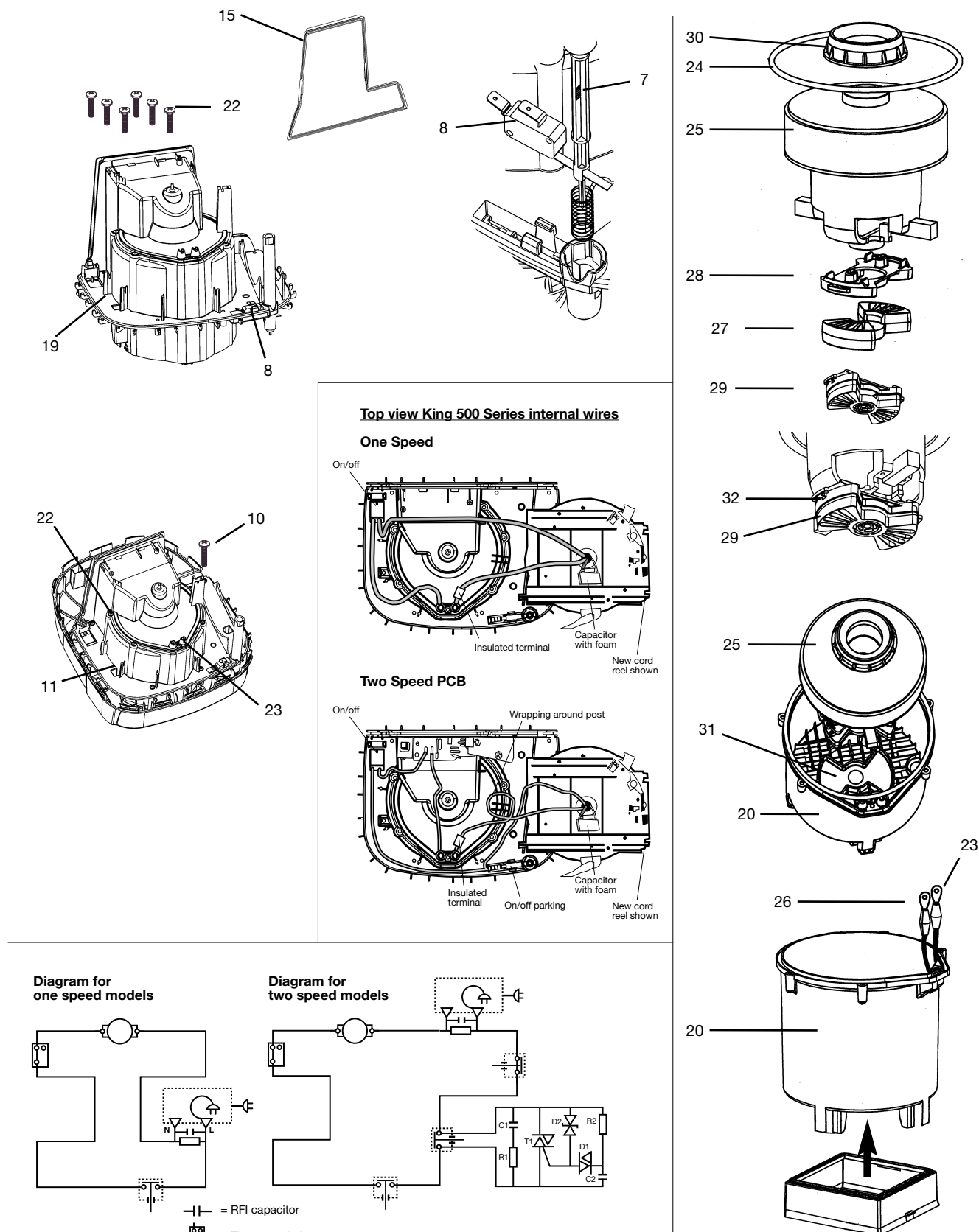

**To be performed by a skilled or instructed person only !**

**Disconnect the vacuum cleaner from the power supply before starting the work!**

- 1. Remove the lid, dust bag, guide and guideway.**

Dust bag  
Guide and guideway



Lid for accessories

- 2. Remove filter and filtergrid.**

Filter and filtergrid

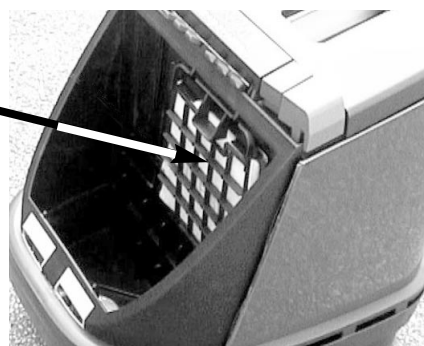

- 3. Place the vacuum cleaner on the top of the disassembly tool.**

Disassembly tool



- 4. Grip the handle firmly. Gently press the front of the vacuum cleaner while simultaneously lifting the handle. Push down to the position shown.**



## 22361400. Disassembly tool of top and bottom housing

A-0.6.5.

28

5. The back of the vacuum cleaner must rest on the internal edge of the disassembly tool.

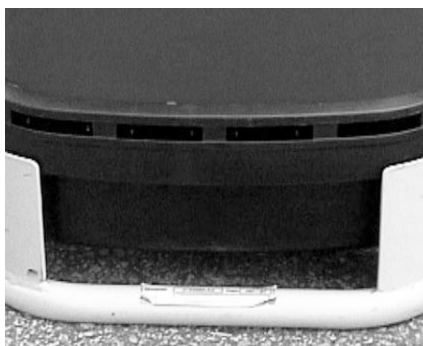

6. Press down the front of the vacuum cleaner as shown.



7. Remove the lid for accessories. Press down the back of the vacuum cleaner. Now you can lift off the buffer.



8. Refit in reverse order. Press the buffer back in place by hand after mounting the strap around the housing.

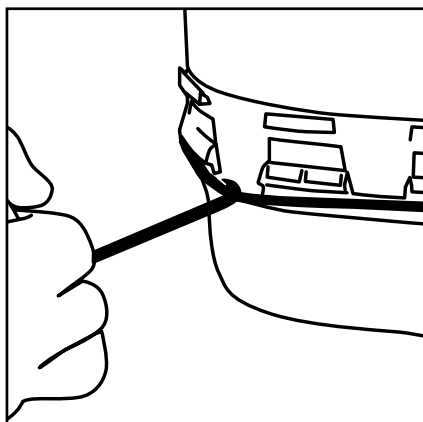

22389400. Inner parts for dustlid with indicator GMxxx & KING

A-0.6.5.

22301700. Dust lid black for models with dust indicator

29

22389300. Inlet for dustlid with dust indicator GMxxx & KING

**To be performed by a skilled  
or instructed person only !**

## **Remove the old dust cover.**

Open the dust cover until it stops and continue with a little pressure by hand until it slides free of the hinges.

## **Assembly new dust cover.**

(1) Apply water or acidfree oil around the inlet on the outer lid.  
(2) Press the inner lid into outer lid. Let the two snaps click into place.  
Screw in the two screws.  
Replaced dust cover in reverse order.

(1)



(2)





22410600

**A-0.6.5.**  
**31**

