

D900.S-CR LED downlight

Datasheet



Product codes

Unit: D900.S	Family: CR	Colour temp. (K): 3K 4K	Beam angle (°): 25 40	Colour: B (Black) W (White)
------------------------	----------------------	--------------------------------------	------------------------------------	--

Photometrics

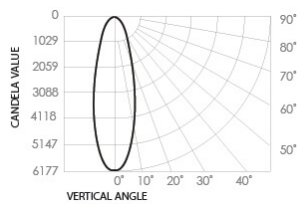

Lumen output: 920lm
Colour temp.: 4000K
Efficacy: 77lm/W
Beam angle: 25°

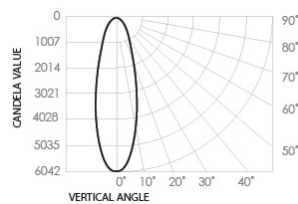

Lumen output: 900lm
Colour temp.: 3000K
Efficacy: 75lm/W
Beam angle: 25°

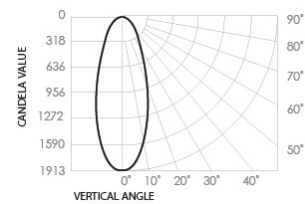

Lumen output: 920lm
Colour temp.: 3000K
Efficacy: 77lm/W
Beam angle: 40°

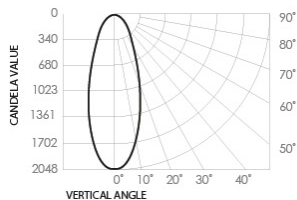

Lumen output: 940lm
Colour temp.: 4000K
Efficacy: 78lm/W
Beam angle: 40°

Dimensions (mm)

Front view

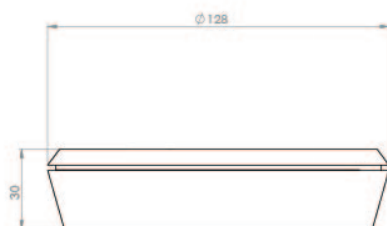

Side view

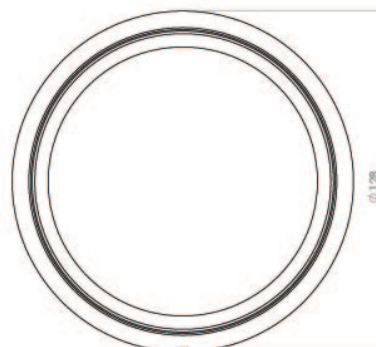

Electrical

Input voltage: 220-240V	Power usage: 12W	IP rating: IP44	Surge protection: Yes	Dimmable: Yes
-----------------------------------	----------------------------	---------------------------	---------------------------------	-------------------------

Operational

Operating temp.: -10 to 90°C	Average temp.: 60°C	Ambient temp.: -28 to 65°C	Lifetime: 70000 hrs (@TA25)
--	-------------------------------	--------------------------------------	---------------------------------------

Physical

Weight: 300g	Warranty: 7 years
------------------------	-----------------------------

Compatibility

Recommended Dimmers:
Clipsal, Universal Clipsal, Trailing Edge
Legrand 400T, Trailing Edge.

*Compatible with many centralised control systems such as Clipsal C-Bus. All systems are unique, please call 1300 672 499 for advice on your installation.

Installation

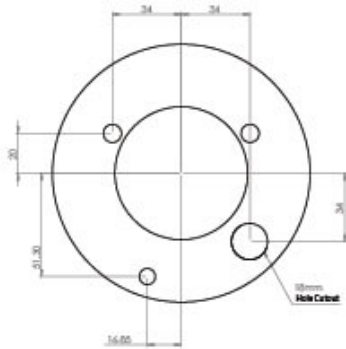

Step 1
Using a guide or the junction plate, mark out the placements of the 3 mounting screws and 20mm hole cut out.

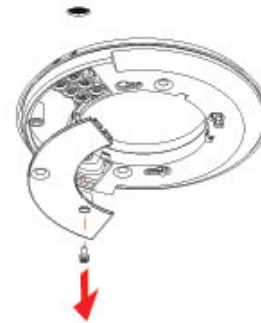

Step 2
Remove the cover on the junction plate by unscrewing the holding screw

Installation



Step 3
Pull the power cable through the junction plate.



Step 4
Strip back the outer insulation on the power cable line to allow approximately 8cm of the inner insulation wire.
Correctly wire the power cable into the junction plate in line with Australian Standards.
Where necessary daisy chain another power cable into the next unit.

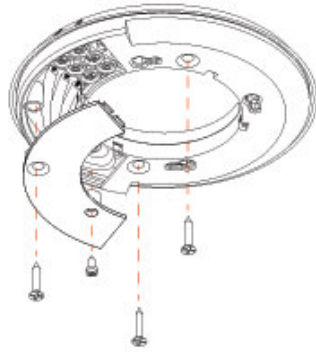

Step 5
Attach the junction plate cap and mount the unit to the roof using the provided screws.

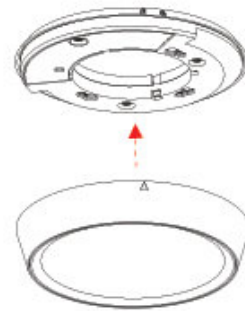

Step 6
Align the luminaire to the junction plate and slot into position, making sure that the contacts points recess into the junction plate.

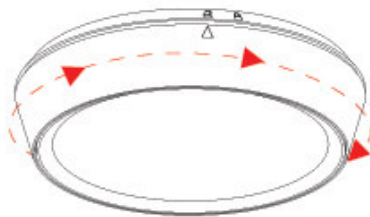

Step 7
Twist the luminaire to the right to lock into position.